

# Burrillville

## Bugle



### Spring—Summer 2016

## Index

Adopt-A-Spot	Page 31
American Legion Hall	" 26
Animal Control Shelter	" 40
Berard-Desjarlais American Legion, Post 88	" 26
Boy Scouts of America	" 65
Commerce Park	" 79
Conservation Commission	" 76
Department of Public Works, Refuse & Recycling	" 54
Emergency Management	" 38
Extended Care	" 25
Farmer's Market	" 23
Finance Department	" 12
Fire Departments	" 80
Historical Society	" 30
Jesse M. Smith Library	" 66
Ladies' Pascoag Library Association	" 70
Lions Club	" 37
Parks and Recreation	" 46
Police Department	" 32
Post Offices	" 81
Power Plant Questions Form	" 11
Redevelopment Agency	" 15
School Department	" 73
Senior Housing	" 29
Sewer Department	" 77
Spring Lake Beach	" 44
State Government Officials	" 83
Tax Assessor	" 27
Town Clerk	" 17
Town Council President	" 4
Town Directory	" 82
Town Manager	" 6

## How to Get Information/Contact Us

---

There are many different ways to get information, public notices and communicate with the Town.

### Town Website



The Town has a website that is full of information for residents and visitors! [www.burrillville.org](http://www.burrillville.org). The website is a great tool to find information out about the Town, obtain contact information for all the different town departments, town budgets and finances, and very helpful EMERGENCY AND CODE RED INFORMATION.

### Public Notices and Newsletters

You can subscribe through the town website to receive newsletters and notices for a wide variety of information and keep up to date on the things currently going on throughout the town! Under the Public Notices and Public Newsletter Links on the town website you can view things like the Town Bulletin Board, Town Meeting Notices and Minutes, Bids and Requests for Proposals, Announcements and Press Releases. You can also view news from the Parks and Recreation Department, current rubbish and recycling information, as well as this edition (along with older editions) of the Burrillville Bugle!

### Local Business Directory

There is a Business Directory to help residents and visitors navigate their way through the Town and locate the local businesses who have registered. If you're a local business, please register at the Business Directory page.

### Visit Burrillville



We have a separate website dedicated to promoting Burrillville's quality of life, the natural beauty and local history of our Town. Visit this website at [www.visitburrillville.org](http://www.visitburrillville.org) or by clicking the appropriate link on the Town of Burrillville website entitled Visit Burrillville!

### Facebook



Like us on Facebook! The Town of Burrillville and the Police Department have Facebook pages. It is another great way for us to communicate with the residents and visitors of Burrillville in this digital age. Both are updated regularly.

## Town Council President

John F. Pacheco III

---



Greetings! Let me open by congratulating our Burrillville Bronco's Boy's Hockey Team on consecutive state championships and a BIG shout out to all our students and athletes for their pride, honor, and sportsmanship. You all represent our town with class, grace, and dignity.

I'm also very pleased with the final outcome of the litigation with Trans Canada. It has been concluded with great benefit for the town. This town council, as well as previous town councils, maintained a strong united front. This is our clear message: let everyone involved know that we will not let the town be taken advantage of in any way.

It is with this same resolve that we have and will approach the proposed Invenergy power plant project. It is vitally important that the Town of Burrillville remain objective while the hearing process is underway. While the town acknowledges there may be some advantages and disadvantages to having the Invenergy plant within our borders, I feel it's important to remain neutral until our own experts have completed their research on behalf of the town and all pertinent hearings are completed.

As always, I encourage everyone's participation in the process. Please stay informed, attend YOUR town council meetings, apply for positions on town boards and commissions and visit the town's website [www.Burrillville.org](http://www.Burrillville.org).



Also, stay informed about the many positive things happening in our town. This summer we will see the start of the long overdue revitalization of Downtown Pascoag. Visit the many number of new and refurbished parks and playgrounds. Our libraries, farmer's market, and parks and recreation department are terrific resources, please attend one of their many fine events. Summer will soon be here, I encourage you to visit Spring Lake Beach, it is truly one of the jewels of our town.



I must acknowledge a great group of concerned citizens that we have here in town. BPAC, the Burrillville Prevention Action Committee. <http://www.burrillvillepac.com/>

This group is headed by our superintendent of schools and our police chief and all are welcomed. This group represents a great cross section of our population with a strong presence of school, police, and healthcare. We welcome ALL and need as much help as we can get, our meetings are held on the first Wednesday of every month at the Wallace F. Lee's Safety Complex. Our focus is on combating alcohol, drug, and HEROIN abuse in our schools and town. I'm always very impressed by the outpouring of support and diverse backgrounds of this group and I can't THANK them enough. In closing, I look forward to seeing you and hearing your comments, questions, and concerns about any and all issues in our beautiful town.

Town council meetings are held on the 2<sup>nd</sup> and 4<sup>th</sup> Wednesdays of the month, 7:00 pm, at the town hall. (Unless otherwise noted.)

**GO BRNCOS!!**

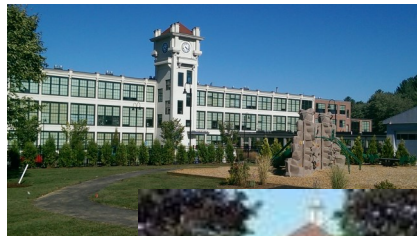

***Burrillville is a  
beautiful place  
to call home!***



## **Town Manager**

Michael C. Wood

---

It is an interesting and exciting time in Burrillville. The past year has brought some very positive developments and some controversy.

### **Downtown Pascoag**

The Town Council has been working with the Redevelopment Agency over many years to make meaningful improvements to Downtown Pascoag. If you've followed my past Bugle articles and my public position, the challenges to improve an older village like Pascoag are many. The laws and regulations passed by both the Federal and State governments make it very difficult to find partners willing to deal with old infrastructure and related environmental, code and other logistic obstacles. Many of the resources the town used to tackle the Stillwater Complex are no longer available or do not apply to the type of problems we face in Pascoag versus Stillwater.

That being said, this Summer and Fall should bring significant change to Downtown Pascoag! New multi-use buildings will replace a number of the current eyesores. Road and infrastructure improvements by the State (and town) are scheduled. Park and recreation areas are being completed.

The Redevelopment Agency and Town Council have been pro-active and patient. This type of positive change can be frustrating with setbacks and unknown twists and turns, but perseverance is what it takes in today's over regulated world.

### **TransCanada Power Plant**

For 5 years the town has been in litigation with TransCanada (the old Ocean State Power). In late 2015, the town settled outstanding litigation with TransCanada. We agreed to a new tax agreement for the next six (6) years.

The TransCanada plant is over 25 years old and is due for a partial or complete overhaul. The town and TransCanada will continue to talk about the status of the plant over the next six (6) years and we will have to re-evaluate future tax agreements based on what TransCanada decides to do. This is important because it could mean the town loses significant revenue should the plant close, we could realize

additional revenue if the plant is upgraded, or possibly something in between. Flexibility is required and has been achieved..

As for the litigation, this was a difficult, very technical and multi-faceted legal process. In the settlement, the parties mutually agreed to a set plant value and related revenue approximating 3 million dollars per year. TransCanada was originally seeking over 8 million dollars in what they claimed were tax overpayments. The town did not have to repay any back taxes (overpayments). The settlement will allow us to address the future state of the plant and better manage its impact on the town and or taxpayers. We are very pleased with the outcome.

### **Invenergy/Clear River Energy Center (CREC)**

The proposed Invenergy/CREC power plant, potentially located on the site of the Algonquin (Spectra) compressor station (Wallum Lake Road), is in the process of being evaluated and potentially permitted. The independent state regulatory board, the Energy Facilities Siting Board (EFSB), is legally responsible to approve the project.

Town Government has no legal authority to decide whether this plant is built or not. The State law is very clear on this point. The EFSB has directed that the Town provide input on important planning and zoning issues related to the project but whatever we provide to the EFSB is advisory only and the EFSB can override our input if they believe it is not factual or well-reasoned.

What we are doing is to provide meaningful and rational responses that address the concerns we all have about the plant. The Town Council has hired independent experts to evaluate the technical and quality of life impacts of the proposed plant. We will review the information submitted by CREC, monitor the state regulatory agencies, and evaluate relevant information provided by those in opposition to the plant.

An interesting, but unspoken factor is that the town has an existing power plant that has been operational for over 25 years. It uses technology that is very old and far less efficient than the equipment CREC is proposing. My guess is that a good majority of the town does not know where the existing TransCanada (Ocean State Power Plant) is located and has not been impacted by its existence or operation. That's not to say there is no impact. But, whatever that might be, it is not evident and has not been identified as anything to be overly concerned about.

The evaluation of the CREC plant will take into consideration the cumulative effect, if any, both plants and the compressor stations may have on the Town, specifically air quality.

Whether we like it or not, the reality is that this power plant has a decent chance of being approved. The Town Council has a fiduciary responsibility to all taxpayers to secure a long-term tax agreement should the EFSB approve the CREC project. If that were to happen, there are potential offsetting financial benefits to both the existing TransCanada and CREC's proposed plants. Many millions of dollars of revenue could be realized to assist local taxpayers. The town will be able to continue with physical improvements and upgrades to our roads and infrastructure, rehabilitation of our villages and making improvements to our schools. We will also be able to continue building and maintaining recreational areas and open space.

Do we want to see the rural character and open space, so important to Burrillville, potentially compromised by the housing build-out that would need to occur to match the revenue potentially realized by these power plants?

These are all relevant factors to consider in the larger discussion of the pros and cons of these power plants.

### **So What's Really Going On?**

A lot of people have inquired about where information is available about the Invenegy/CREC power plant, and how the process works.

CREC filed over 470 pages of information back in October of 2015. That filing and all subsequent filings with the EFSB are available by going directly to the Energy Facilities Siting Board (EFSB) website or you can link to it from the "Power Plant" link on the town's home page <http://www.burrillvillepac.com/>. There are over 50 documents on the EFSB website. That information is only the starting point in the process to evaluate the proposed plant and, believe me, there is plenty of information to look through! Please use the Town's website to keep up to speed on the project.

The EFSB held a preliminary hearing that concluded on January 26, 2016. As a result of that hearing, a number of orders and directives were considered based on the town's concerns and matters raised at this hearing, both for and against the plant.

On March 10, 2016, the EFSB issued the aforementioned orders and



directives to a number of different entities soliciting additional information. These can be found on the town and EFSB's websites. State agencies such as the Department of Environmental Management (DEM), the Public Utilities Commission (PUC) and the Department of Health (DOH) were tasked to independently evaluate most of the sensitive environmental issues. Those state agencies, as of this date, have just started their own evaluation processes.

So, what does this mean? It means that the full picture is not known at this time and it won't be known until all the information and evaluation requested by the EFSB is completed; there is a 6 (six) month window for the EFSB to conclude this part of the process. That window closes in mid-September 2016. A final decision by the EFSB could come as late as February 2017.

Unfortunately, some of the rhetoric, including various paid advertisements and handouts being distributed throughout the town are questionable in nature and premature. Everything needs to be put into context. Information can be presented in such a way as to cause alarm or structured in a way to sway us to a particular point of view. However, when it's impartially evaluated, it may not be a problem or not as bad as portrayed. On the flip side, Invenergy/CREC might try and downplay or skew information about the plant or possibly exclude relevant information (or parts thereof) in their submissions. The point I'm making is that it's our job, along with the EFSB and other regulatory agencies, to cut through the fog and properly evaluate the issues that are relevant.

As previously mentioned, the Town Council has hired its own experts to independently review and evaluate the project. We will participate, where allowed, in the various processes by DEM, the Public Utilities Commission (PUC), Department of Health (DOH) and other agencies or groups who are legally entrusted to evaluate the plant and its impact on our town. This is the best way we can make our voices and concerns known!

The town will formally respond to relevant concerns when the full picture is known. And, that is not the case at this point in time!



### **Finance Director**

Longtime Finance Director, John P. Mainville, has resigned and taken a similar position in Florida. John served the community for approximately 29 years and is just one of a long line of Mainvilles who have given service to our community.

Our thanks to John for his time, effort, and service and for assisting the town council and town manager to keep Burrillville financially strong and proactive.

Best of luck to John and his family in sunny Florida!

### **The American Legion Hall**

103 Harrisville Main Street  
Harrisville, RI 02830  
401-568-4300 ext. 137



### **The Legion Hall is available for rent!**

Looking for a great place to hold a birthday party, family gathering, bridal or baby shower? The Legion Hall, located at 103 Harrisville Main Street (next to the Town Hall) is available for rent. The hall is also suitable for small workshops or meetings. The Legion Hall is comfortably air conditioned for use in the summer.

The Legion Hall contains a full kitchen, including an electric stove, microwave and refrigerator. Tables and chairs are also available for use. For rental details, please contact Maggie Pienkos, Clerk-Treasurer, Board of Administration at (401) 568-4300 ext. 137 or by email at: [boa@burrillville.org](mailto:boa@burrillville.org).

## Have Questions about the Power Plant proposed for Burrillville?

The Town of Burrillville has put together a panel of experts to sort through the information that is being circulated about the proposed power plant. Please send your questions about the power plant and we'll get the Burrillville team working on answers. Use this form to submit your questions or email to: [lphaneuf@burrillville.org](mailto:lphaneuf@burrillville.org)

Answers will be posted on the [Frequently Asked Questions](#) area of the [Invenenergy page](#) on the town website.

Share your questions with the Town of Burrillville	
Optional: Please provide contact info in case we have questions or need more information	
Name	Email
Phone	Address

**Send your questions to:**

Town of Burrillville  
105 Harrisville Main St, Harrisville, RI 02830

For more information contact the Burrillville Town  
Manager's office at 568-4300, Ext. 115.  
[www.burrillville.org](http://www.burrillville.org)



## Finance Department

---

### **Current Budget – Fiscal Year Ending June 30, 2016**

The Budget for fiscal year ending June 30, 2016 in the amount of \$47,908,356 was adopted on June 10, 2015. The budget represents an increase of \$1,253,721 more than FYE 2015 of \$46,654,635.

The 2016 Budget includes the following allocations: \$30,610,000 for School Department Operations, \$9,711,577 for Municipal Operations, \$2,549,733 for Debt Service, and \$3,507,046 for Capital Improvements.

A tax levy of \$30,848,180 was required to balance the budget. This represents an increase of \$937,681 over the fiscal year ending 2015 tax levy.

### **Proposed Budgets – Capital and Operating Fiscal Year Ending June 30, 2017**



### **Capital Budget**

The Budget Board has met with each department and forwarded its recommendation for capital improvements to the Manager. The Public Hearing for the Capital Budget will be on **March 23, 2016**.

### **Operating Budget - Ongoing Budget Process**

The Budget Board will forward its recommendations to the Town Manager by April 4, 2016. The Town Manager in turn will make his recommendation to the Town Council by the end of April. There will be **two Public Hearings** on the Budgets. The first Public Hearing will be on **May 19th** to go over the Municipal Budget and a second hearing will be on **May 26<sup>th</sup>** for the School Operating Budget. Both hearings are currently scheduled for the Council Chambers. The Town Council is scheduled to consider the adoption of the FYE 2017 Budget at the June 8<sup>th</sup> Council Meeting.

### ***A message from the Finance staff***

*On March 3, 2016 the Town bid a fond farewell to its Finance Director, John P. Mainville who has retired after a distinguished 29 year career. His career is long and full of tremendous achievements. He has seen the Town through many credit rating upgrades in a time when other communities are seeing their ratings downgraded, through his implemented debt management practices; a reduction in the Town's debt from 183% of the state average in 1993 to 59% of the state average currently with an overall savings of \$6 million dollars to the Town over the years, insurance coverage reductions, and many technological upgrades within the Town Hall and adjunct departments.*

*The Town owes a debt of gratitude to Mr. Mainville for his fiscally responsible tactics and his overall commitment to the Town and its residents. We wish Mr. Mainville a happy and healthy retirement and best of luck in his future endeavors.*

### **Taxes**



The 2015 tax bills were mailed July 9, 2015, the 4<sup>th</sup> quarter payment is due April 15 - May 2, 2016. Any payments received after May 2, 2016 will be assessed interest (12% annualized) as required by law. Any delinquent 2015 taxes are assessed interest retroactively to August 1, 2015.

This year's annual tax sale is scheduled for June 16, 2016 at 2 p.m. in the Council Chambers, located at 105 Harrisville Main St., Harrisville, RI 02830. The Town also participates in State programs such as placing blocks with the RI Registry of Motor Vehicles (DMV) and RI Income Tax Refund Offset program to aide in the collection of delinquent taxes.

### **\*\*NEW PAYMENT OPTION\*\***

#### **Automatic Clearing Hours (ACH) payments are now available.**

We can debit your checking or savings account for FREE, on a monthly or quarterly basis on the 15<sup>th</sup> of the month, or once annually. Enrollment in ACH will eliminate blocks at the DMV.

Applications are available online at [www.burrillville.org](http://www.burrillville.org) under "Forms & Documents" or in the Tax Office. ***Please allow one week to set up or cancel the debit.***

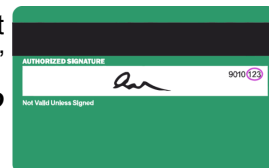

### **Online Reminders**

Sign up on our website under "E-subscribe" for quarterly reminders of upcoming due dates. Be sure to check off "Tax Collector". Go Green, and update our office with an email address, so payment receipts and other correspondence can be emailed.

Check your tax balances and make payments online at [www.burrillville.org](http://www.burrillville.org) under "Pay Taxes". You can find your account number and PIN on your tax bill. If you do not have your bill, please contact the Collector's Office at (401) 568-4300 Ext. 141. Credit/debit card payments are also accepted in the Tax Office (no payments will be accepted over the phone). **All card payments are charged a convenience fee of 3% with a minimum of \$2.00.**

A drop box is available near the rear entrance of the Town Hall for your convenience. Please **do not put any cash in the drop box** – checks or money orders only.

***Returned checks/payments for whatever reasons are assessed a \$35.00 fee.***

### **Did not receive a bill?**

Failure to receive the tax bill does not eliminate the requirement for a timely payment of any taxes that are due. If you have any questions please call the Tax Collector's Office at (401) 568-4300 Ext.141.

Returned mail is re-mailed if a new address can be identified. If you move, please contact the tax assessor's office to update your mailing address.

### **Motor Vehicle Registrations/Renewals**

Registration blocks are sent to the DMV for all delinquent motor vehicle taxpayers. If a block is placed with the DMV, ALL motor vehicle taxes under your name must be paid in full by cash, money order or credit card. A personal check will delay the release by 10 business days. Please note the registration block may take up to 48 hours to be released by DMV after the request for release is made.

If you move, it is imperative that you contact the DMV and the Tax Assessor's office to update your address. All tax bills are mailed out by the 2<sup>nd</sup> week of July each year. If you do not receive a bill, please contact the Assessor's Office.

### **Are you Having Financial Difficulties?**

If you are having financial difficulties, please contact the collector's office as soon as possible. Early intervention is the key to the Town's ability to be of assistance.

## **Burrillville Redevelopment Agency**

### **James Langlois, Chairman**

---

In 20015 the Burrillville Redevelopment Agency took on the task of identifying areas in the community that met the sub-standard or blighted standard. After visiting and investigating many potential sites throughout the town, and after further discussion and analysis a weighted and criteria based formula was used to determine sites that could become redevelopment districts. Four sites were presented to the Burrillville Town Council in January of this year. From highest to lowest rank the following areas were accepted by the council.

**Nasonville:** Corner of RT 102 and RT 7. (Old Turex Mill Site)

**Oakland:** (Former Remington Lumber site)

**Harrisville:** Chapel Street from River Street to Union Avenue

**Pascoag:** North Main Street, Grove Street to north corner of Centennial Street

**Furthermore, the council voted to authorize the administration and the Redevelopment Agency to begin moving forward with the Nasonville Mill site.**

Residents of the town can be assured that the Burrillville Redevelopment Agency will diligently develop a plan for this area that will be well thought out and carefully executed to enhance and improve this section of our community.

---

#### **E-Subscribe**

<http://www.burrillville.org/subscribe>

*Select which Burrillville alerts, news and announcements you wish to receive right to YOUR email.*

### **Downtown Pascoag Redevelopment District**

Redevelopment of Main Street will begin in the spring of 2016. National grid has installed gas lines under the street and State of Rhode Island will begin the rebuilding of RT 107 through Main Street to Union Avenue.

- ◆ Several buildings will be demolished in the downtown section to make way for a new structure that will house the expansion of Well One Services to the area including an X-ray and imaging facility. Retail, Office, and Housing space will also be created.
- ◆ A foot bridge over the Pascoag River will be constructed to connect the Riverwalk and existing Well One campus.

This will bring a major change to the area. New business opportunities and improved quality of life are only few of the benefits we hope to realize from this project.



### **The Stillwater Mill Center Pavilion is available to Rent**



Visit the website below  
for rental use  
application and  
rate details.

<http://www.burrillville.org/parks-recreation/pages/forms-procedures>



**Town Clerk**  
**Louise R. Phaneuf**  
**Town Building Hours**

Mon – Wed: 8:30 a.m. – 4:30 p.m.

Thurs: 8:30 a.m. – 7:00 p.m.

Fri.: 8:30 a.m. – 12:30 p.m.

*No Land Evidence is recorded during the last half hour of any day.*

- 
- |                      |  |
|----------------------|--|
| ♦ Notary Public      | ♦ Marriage License                     |
| ♦ Probate Court      | ♦ Dog Licenses                         |
| ♦ Recorder of Deeds  | ♦ Hunting & Fishing Licenses           |
| ♦ Voter Registration | ♦ Birth, Marriage & Death Certificates |

**Fishing Licenses**

The Rhode Island Department of Environmental Management offers fishing licenses for sale through their website at:

<https://www.ri.gov/DEM/fishinglicense/>

The DEM website also includes a list of all vendors authorized to sell hunting and fishing licenses, including the Burrillville town clerk. You can purchase hunting and fishing licenses at the town building during our regular hours of operation. A previously issued Rhode Island hunting license or hunter's safety card must be submitted with application for a hunting or combination license.



**Permanent Fishing/  
Combination Licenses**

Persons who are 100% permanently disabled are eligible for a fishing/combination License. Applicants must contact Rhode Island Department of Environmental Management.

Anyone age 65 or older is eligible for a fishing/combination license at no charge and does require identification. Permanent licenses for anyone over 65 are available at the town clerk's office.

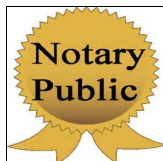

**Notary Public**

Notary public services are available at the town building during regular hours. There is no fee for this service.



### **Contact your elected officials**

There are many ways that residents can keep up with Council activities.

- The Council's web page is updated regularly. There you can find reports, agendas, minutes, resolutions and policies.
- Councilors' addresses and phone numbers are listed on-line and are available at the town building. Don't hesitate to call on Councilors with questions or comments.
- Each Councilor has a mailbox at the town building.
- Correspondence can be dropped off or mailed there.
- To see the Council in action, stop by a meeting, held the 2<sup>nd</sup> and 4<sup>th</sup> Wednesday at the town building.
- If you have ideas for information you'd like to see on our website, contact your local Councilors.
- Burrillville News is published on the town website periodically, subscribe to the public notices to receive the newsletter.

### **Town Council**

Regular meetings of the Burrillville Town Council are scheduled for the second and fourth Wednesday of each month at 7:00 p.m. in the Town Council Chambers, Town Building, 105 Harrisville Main St., Harrisville, RI 02830. Schedule changes are posted at the town building and on the town website.

To appear before the Town Council, submit a written request to the town clerk's office by 4:00 p.m. on the Thursday before each meeting.

At least 48 hours prior to any Town Council meeting, agendas are posted at the town building, the Jesse M. Smith Memorial Library, at the Harrisville Post Office and on-line at the town's website at [www.burrillville.org](http://www.burrillville.org).

The Town of Burrillville will provide accommodations needed to ensure equal participation. Please contact the Burrillville town clerk at least three (3) business days prior to the meeting so arrangements can be made to provide such assistance at no cost to the person requesting it. A request for this service can be made in writing or by calling (401) 568-4300 (voice) or "via RI Relay 1-800-745-5555" (TTY).

### **Burrillville Volunteer Opportunities**

The Burrillville Town Council has established more than a dozen boards, commissions and committees comprised of resident volunteers. If you would like to volunteer for a committee, please complete the application included in the Bugle and submit it to the town clerk's office.

## **Burrillville Video Archives**

To access a Town Council meeting on the internet:

- 1) Visit [www.burrillville.org](http://www.burrillville.org)
- 2) Click on **Government** tab at the top of the home page.
- 4) Clicking on Meeting Video link will bring you to the video archives.

## **Minutes & Agendas**

Town Council agendas, minutes and videos can be searched from the video archives page. Use a key word in the "search archive" feature on the page. The search result will be a link to the point on the video where the searched item was discussed. The result will also include the agenda and minutes where the item is mentioned.

### ***Other ways to view!***

#### **Public Access Television**



Burrillville council meetings are aired on Public Access television. That's Channel 18 on Cox and Channel 22 on Verizon. Public access shows the most recent meeting, usually for two weeks.

## **Lending Library**

When a new meeting file is delivered to public access, the previous file is returned to the Town. [Jesse M. Smith Memorial Library](#) librarians archive the videos for easy access by the public. View videos at the library or borrow them to watch at home using a DVD player.

## **Vital Records**

### ***Birth records available statewide***

Certified birth records for many people born in Rhode Island can be issued at all city and town clerks offices. Call the town clerk's office at 568-4300 to find out how to obtain the record you need.

### ***Birth, Death & Marriage Certificates***

- The town clerk's office provides certified copies of birth, death and marriage records. The fee is \$20.00 for the first copy. Additional copies of the same record are \$15.00 if obtained at the same time.
- Birth and marriage records that are 100 years old or less and death records that are 50 years old or less are confidential.
- Please contact the town clerk's office for information on who can apply for or obtain vital records.

### ***Vital Records by mail***

The Burrillville town clerk's office will accept a mail request for a birth, marriage or death record. The certified copy is usually mailed to the applicant on the same day it is received in the town clerk's office. To receive a certified copy of a birth, death or marriage record via mail you must send a readable copy of your picture identification and a completed application which you can find on the town clerk's page of the town website. If you cannot access the application, please provide the following information:

- the name on the birth, death or marriage record
- the date and city/town where the event occurred
- your relationship to the person named on the record
- why you need the record
- for births only, provide the name of the father and the mother's maiden name
- your signature and printed name  
your mailing address and your home phone number in case we need to contact you.

Please send payment with your request. The fee is \$20.00 for the first copy. Additional copies of the same record are \$15.00 if obtained at the same time.



### **Marriage Licenses**

***Rhode Island residents:*** Couples should apply for a marriage license at the clerk's office in the city/town where one (or both) of the parties reside. If at least one of the parties lives in Rhode Island, the marriage license is valid in any city or town and the ceremony may take place anywhere in Rhode Island.

***Non-residents:*** If neither party lives in Rhode Island, the license must be obtained at the clerk's office in the city or town where the ceremony will take place.

- Both partners are responsible for presenting proof of birth facts (preferably a certified copy of the birth certificate) and a valid form of identification.
- If previously married or in a civil union, a certified copy of the final decree of divorce or dissolution of the civil union (with the raised or original stamped court seal), or a certified copy of the death certificate of the deceased previous spouse.
- Marriage licenses cost \$24. The license is valid for 90 days.

## Burrillville Board of Canvassers



### How do I register to vote?

You can register to vote in Rhode Island by completing a voter registration form which may be obtained at the Burrillville Board of Canvassers at the town building or the RI Board of Elections. You can also download the form from the State Board of Elections website: [www.elections.state.ri.us](http://www.elections.state.ri.us). Many agencies which serve the public, such as the Department of Motor Vehicles, Department of Human Services, and the Department of Mental Health offer voter registration services to their clients as mandated by the National Voter Registration Act.

### VOTER ID

Rhode Island state law 17-19-24.2 requires all voters to present valid photo identification prior to voting at the polls in all elections beginning in 2014. Voters will need to present one of the following forms of photo ID:

- Photo ID
- RI Driver's License
- RI Voter ID Card \*
- U.S. Passport
- Photo ID issued by a U.S. educational institution
- U.S. military photo ID
- Photo ID card issued by the United States or the State of Rhode Island
- Government issued medical card with photo

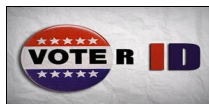

\*The Rhode Island Secretary of State's office is issuing free voter photo ID cards to individuals who do not possess any of the valid Photo IDs listed above. See the Secretary of State's website for additional information on the program, or call (401) 222-2340.

### Protecting Your Vote

No eligible voter will be turned away at the polls. Voters who do not bring ID to the polls can vote using a standard provisional ballot.

### Rhode Island Voter Information Center:

<http://www.sos.ri.gov/elections/voters/>

- Check your voter registration
- Find your current elected officials
- View sample ballots for upcoming elections
- Locate your local board of canvassers
- Find where to vote



## **Mail Ballot Overview**

Any otherwise qualified Rhode Island voter may vote by mail ballot in the following circumstances:

1. A voter within the State of Rhode Island who is incapacitated to the extent that it would be an undue hardship to vote at the polls because of illness, or mental or physical disability, blindness, or serious impairment of mobility.
2. An elector who is confined to in any hospital, convalescent home, nursing home, rest home, or similar institution, public or private, within the State of Rhode Island. <http://www.elections.ri.gov/voting/nursing.php>
3. An elector who will be temporarily absent from the state because of employment or service intimately connected with military operations or who is a spouse or legal dependent residing with that person, or a United States citizen that will be outside of the United States. (Please Note: any voter qualified to vote a category 3 mail ballot will also be allowed to cast a mail ballot pursuant to the Uniformed and Overseas Citizens Absentee Voting Act "UOCAVA Act" <http://sos.ri.gov/elections/voters/overseas/> )
4. An elector who may not be able to vote at his or her polling place in his or her city or town on the day of the election (see "No Excuse Mail Ballot Voting" below).

All mail ballots must be received by the State Board of Elections at 50 Branch Avenue Providence, R.I. 02904 by 8:00 p.m. the night of the election.

## **No Excuse Mail Ballot Voting**

Rhode Island has joined 30 other states and the District of Columbia that now allow no excuse mail ballot voting. If you may not be able to get to the polls on Election Day, you can fill out a mail ballot application and receive a mail ballot.

## **More on voting by mail**

Applying for a Mail Ballot

<http://www.elections.ri.gov/voting/applymail.php>

Emergency Mail Ballots

<http://www.elections.ri.gov/voting/emergency.php>

Military and Overseas Voters

<http://sos.ri.gov/elections/voters/overseas/>

Mail ballots do not require voter ID.

Find more about Voter ID at [www.sos.ri.gov](http://www.sos.ri.gov)



## **The Burrillville Farmer's Market Deb Yablonski, Market Manager**

The Stillwater Mill Pavilion  
75 Tinkham Lane  
Harrisville, RI 02830  
401-568-3191

[burrillvillefma@gmail.com](mailto:burrillvillefma@gmail.com)

---

### **2016 marks our 10<sup>th</sup> season**

Opening Day is May 21<sup>st</sup>

Hours of Operation: Saturdays 9:30 to 12:30 p.m.

#### **Join Us!**

Just follow the signs to get here!

The Burrillville Farmers Market is a nonprofit organization, whose mission is to improve the promotion and marketing of agricultural products in the town of Burrillville and our surrounding communities. The market's goal is to nurture community appreciation of the consumption of wholesome, local foods, natural products and art in a lively neighborhood setting. By supporting local farmers and artisans, we hope to preserve farmland and the quality of rural life in our beautiful Burrillville community.

The Burrillville Farmers Market Association encourages a greater sense of community, through fostering local business development, as well as providing educational opportunities for the entire family. We are striving to bring to a diverse shopping experience, and to create a community gathering place filled with energy. We hope you'll join us to reduce our carbon footprint and encourage a sustainable food system and lifestyle right here in Burrillville!

We hope you are dreaming of warmer days & are looking forward to sharing another great summer with us. We will be celebrating our tenth season this year! With several of our original farms still participating & many new farms & artisans, who have joined us, we are mindful that we couldn't do this without the continued support of our Burrillville community. We look forward to sharing a season long celebration of all things good & plentiful. As usual, we will be offering free seeds, provided by the U.R.I. Master Gardeners.

We will have a wide assortment of fruits, vegetables, herbs, eggs, honey, jams, soaps, rubs, plants, baked goods, chicken and art. We are very lucky to have local musicians who share their talents every week!

We welcome many community groups and organizations to the market, to raise awareness of their missions.



Everyone is encouraged to enjoy our gardens alongside the pavilion. These gardens were created through the efforts and donations of our Vendors, Friends, Burrillville DPW, Seven Hills Rhode Island and Roots and Shoots Nursery. We are thrilled to see how these gardens have evolved through the combined efforts of so many hands! Please enjoy them!

We will once again be joining the Town of Burrillville, Parks and Recreation Department, Pascoag Utilities, & Jesse Smith Library on several occasions to bring you some special events, such as the Family Fair on June 18th, and The Green Fest on September 10th. To stay informed of all our upcoming events, check out our website, look for our Bargain Buyer ads & follow us on Facebook!

We hope you'll come to our market and bring your family, meet up with friends and reconnect with the cycles of nature. We invite you to meet the farmer who so lovingly grows your food or bakes the bread, using ingredients they've grown! Listen to some fine music, purchase that unique gift from the artist who created it and most importantly be a part of our wonderful rural community!

***\*We accept Credit/Debit, EBT (Bonus Bucks!), WIC, Senior Farmers Market Nutrition Coupons (available at the market) and Cash!***

***\*Come share your creative energy, there are so many ways to be involved! Opportunities are available for Vendors, Volunteers, Musicians, Community Service, etc.***

[www.burrillvillefarmersmarket.org](http://www.burrillvillefarmersmarket.org)



## **Information Systems Department**

### **Ed Pienkos, Director**

- Continuing to replace and / or upgrade computer hardware town wide as needed.
- Switched municipal buildings over to using an internet connection for their wide area network access. Provides a faster response time for less cost.
- Working to implement a new town wide telephone system so all buildings will be on a common platform for telephone service.



## **Burrillville Extended Care**

**Kelly E Cournoyer, Director**

P.O. Box 351, Harrisville RI 02830

Telephone 568-1356

e-mail: [kcournoyer@burrillville.org](mailto:kcournoyer@burrillville.org)

---

*"I continue to believe that if children are given the necessary tools to succeed, they will succeed beyond their wildest dreams!"*



by David Vitter

The Burrillville Extended Care Program offers before and after school care for children in Kindergarten through 5<sup>th</sup> grade at the Steere Farm and Callahan Elementary Schools. The Program also offers a full-time care program during school year vacations and holidays.

### **Upcoming April Vacation 4-8-16 to 4-22-16**

If you're looking for full time care during April Vacation, we will be open Mon-Fri, 6:30-6:00pm

Contact the BEC Main office to register your child for days needed during the April Vacation.

### **Summer Camp 2016**

Registrations for our Summer Camp Program begin on April 1, 2016. Our Summer Program is available for the entire summer, **estimated start date is June 13th, 2016**. We operate Mon-Fri 6:30am-6:00pm, **July 4th**, the center will be closed. Our Summer Program accepts children entering 1st to 7th grade or age 12, due to our licensing through RI DCYF.

Kindergartners are only eligible to begin the program once they are enrolled and have started Kindergarten

Information and Registration Forms are available on our website:

<http://www.burrillville.org/burrillville-extended-care-program>

Or by calling the office at 568-1356 X10



### **The BEC Board of Directors needs Members!**

BEC is currently looking for volunteers to serve on our Board of Directors, which meets on the 1st Tuesday of every other month at 6:30 PM. There is a stipend paid for meetings attended. If interested please contact the Town clerk for information and an application, 401-568-4300.

Be sure to "Like" our Facebook page for the latest news and updates!

## **Berard-Desjarlais American Legion Post 88**

111 Chapel Street Harrisville, RI 02830

[www.legionpost88ri.org](http://www.legionpost88ri.org)

---

The American Legion was chartered and incorporated by Congress in 1919 as a patriotic veterans organization devoted to mutual helpfulness. It is the nation's largest veteran's service organization, committed to mentoring youth and sponsorship of wholesome programs in our communities, advocating patriotism and honor, promoting strong national security, and continued devotion to our fellow service members and veteran's needs.

The Post supports many community programs and provides a meeting place for Burrillville organizations. Linda Peck, Town and Post Service Officer is the Veterans Representative who gives advice and counsel to veterans and their dependents concerning the rights and benefits available to them. She is well-versed about matters such as pensions and hospitalizations. She can be contacted by email: [ldp24@cox.net](mailto:ldp24@cox.net). For any emergencies, please contact Linda Peck at 401-568-8491.

Conrad Zahn has taken over the duties of Building Coordinator. He will maintain the schedule at the Binns Building and can be reached at 401-401-651-6403 or by e-mail at [doczahn@cox.net](mailto:doczahn@cox.net). Please contact Conrad for any town organizations or party rental. If you would like to become a member of the Post, please contact Commander Raymond Trinke at [raytrank101@cox.net](mailto:raytrank101@cox.net) or at 401-568-0858.

Post Flag Sale Saturdays April-October

or by e-mail at [doczahn@cox.net](mailto:doczahn@cox.net).



We now collect used clothing for the needy in the donation shed located outside our post home.



We also continue to collect and properly retire worn flags as a service to our residents!

## **Tax Assessor**

**Susan Makar**

Office Hours: Mon thru Wed 8:30 a.m.- 4:30 p.m.,  
Thurs 8:30 a.m.– 7:00 p.m. and Fri 8:30 a.m.-12:30 p.m.

---

All taxpayers are welcome to stop in the Assessor's Office for a copy of your property record card and the Assessor's map showing your land lines. There is no charge to the homeowner for this information.

If you have moved in the last year please check with the Assessor's Office to be sure your current address is on file with us. The law requires you to notify the Division of Motor Vehicles within 10 days of any change of address if you have any registered vehicles.

Exemptions available to Burrillville taxpayers include Senior, Disability, Blind, Veterans, Prisoner of War and Gold Star Parent. The senior and Disability Exemptions are income based and must be renewed annually. To qualify for a senior exemption you must be 62 years of age and you must have owned and occupied residential property in Burrillville during 5 of the 6 years prior to filing application. Applications must be received by December 31, for the next tax roll. There is one senior exemption allowed per household. If you qualify, please stop in to the Assessor's Office with proof of age.

The Disability exemption is available to taxpayers who are totally disabled and receiving benefits. A copy of the "Notice of Award Letter" is required to receive the exemption. Each year upon renewal you must submit a copy of your "New Benefits Letter" to receive the exemption for another year. If you have any questions with regards to available exemptions please call the Assessor's Office at 568-4300, ext.125 or 126.

### **\*Exemption Application Deadlines\***

December 31, 2016 for Seniors and Veterans

January 31, 2017 for Disabled

Qualified exemptions will be applied to the 2017 tax bill.

## **Information & Services for Seniors**

### **Jane Dubois, CIS**

84 Social Street, Woonsocket, RI 02895

Phone: 766-3734 Fax: 766-5578

---

Jane Dubois, a Community Information Specialist from Senior Services, Inc. is available to assist and advise senior residents of Burrillville. Please call Jane for an appointment for information and assistance and applying for programs you may be eligible for.

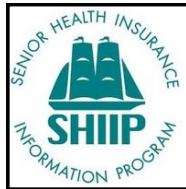

The Specialist is also trained as a Senior Health Insurance Program (SHIP) Counselor and can explain health insurance options available to Rhode Island seniors so that they can make choices concerning their health care.

Understanding Medicare enrollment periods can help you prevent gaps in coverage and avoid financial penalties.

- **Know when to sign up for Medicare Part A and Part B.**
- **Know when you can routinely make changes to your Medicare coverage.**
- **Know whether you are eligible for a Special Enrollment or Special Election Period.**

**(Volunteers are always needed in SHIP and Senior Medical) Patrol**

For additional information contact your local POINT Network Partner.

### **Services Available If Eligible**

Assisted Living Facilities. Caregiver Abuse, Financial Assistance, Fraud/ Waste and Abuse, Health Insurance, Heating Assistance, Home and Community Care Co-Pay, Identification (DEA/RIPTA), Home Equity Conversion, In Home Services, SNAP (Food Stamps), Legal Assistance (Living Wills, Health Care Power of Attorney, Medicare, Medical Assistance (Medicaid) Long-term care, Property Tax Relief,(1040H) Respite Care, RI Pharmaceutical Assistance, Transportation.

\*Referrals to other agencies\*

To reach the town's webpage devoted to news and information for seniors, go to the town website ([www.burrillville.org](http://www.burrillville.org)) and click on the "Senior Services" button on the left. In addition to *Senior News*, the page contains useful links and information on services and programs available to residents. The site covers topics such as Social Security, RIPAE, State identification cards, RIPTA, senior dining – and more!

---

## **HUD SUBSIDIZED SENIOR HOUSING HOUSING ASSISTANCE**

---

### **Ashton Court**

Burrillville Housing Authority  
Joanne Fournier, Executive Director  
77 Ashton Court, Harrisville, RI 02830  
Tel: 568-6200 Fax: 568-4735

***Our mission is to provide decent, safe and sanitary housing for elderly/handicapped-disabled: Public Housing and Section 8 existing housing program.***

### **Bradford Court**

Stephanie Provencal, Property Manager  
45 North Main Street, Pascoag, RI 02859  
Tel: 568-5403 Fax: 568-1717

***We accommodate residents 62 and older, as well as handicapped and disabled with a preference to the elderly.***

### **Stillwater Heights Housing**

Theresa Stelmach, Property Manager  
30 Central Street, Harrisville, RI 02830  
Tel: 710-7344 Fax: 710-7346

***We provide independent living accommodations for residents 62 and older who meet HUD income guidelines.***



## **Burrillville Historical and Preservation Society**

16 Laurel Hill Avenue, Pascoag, RI 02859  
Phone: 568-8534 email: [bmencucci@verizon.net](mailto:bmencucci@verizon.net)

---

### **Come Visit Us**

The Burrillville Historical & Preservation Society's mission is to preserve and protect Burrillville's history. The Society meets on the 4<sup>th</sup> Tuesday of each month at 7:00 p.m. at its headquarters, the Bridgeton School in Pascoag. This 1897 schoolhouse serves as a repository for a collection of photos, documents, histories, scrapbooks, cemetery information, clothing and artifacts. The schoolhouse is open during monthly meetings, special events and by appointment.

### **Looking for Your Photos**

We will be holding an event this summer called "Farm Days" where we will be highlighting some of Burrillville's old farms. We are seeking old photos of farms, farmers, farmhouses, and farm animals in Burrillville. You don't have to give us your original. We can scan your photos and return your originals. We are also looking for any photos of Burrillville soldiers during WWI.

### **You're Invited**

The State Legislature has declared April 16, 2016 to be Rhode Island Historic Cemetery Restoration and Awareness Day. We will be spearheading cemetery work to take place on or close to that date. The public will be invited to join our efforts. Watch for an ad in the Bargain Buyer and on our Facebook page.

### **Volunteers Needed**

We are looking for volunteers to help us with cemetery cleanings. The work involves cutting brush, weed-whacking and raking leaves. You can also Adopt-A-Cemetery and take on the responsibility of maintaining a cemetery yourself. This commitment usually takes about 2-3 hours a year. We are also putting up new signs in cemeteries. If you know of a cemetery with an old rusty or missing sign please contact us.

You many have seen our Gravestone Conservation Team working to restore the town's historic graveyards. Last year we completed work in the Richardson Lot #37, the Keach Lot #105, and the Brown-Millard Lot #2.

## Adopt-A-Spot

*Adopt-A-Spot locations and those who make them BEAUTIFUL!*

Veterans Park adjacent to waterfall	American Legion Hall Post 88
Bella's Restaurant intersec- tion	Bella Restaurant
Bridgeton-Mill Village sign & around 2 rocks	Paige Spink in Honor of The Spink Family
Route 102 Gateway	Burrillville Conservation Commis- sion
Jesse Smith Library Top of Stairs	Burrillville Democratic Committee
Cleans ups throughout Town	Burrillville Garden Club
Pascoag Bridgeway Historical Artifact	Burrillville Garden Club
Commerce Park Entryway	Burrillville Industrial Foundation
Firefighters Memorial Park	Harrisville Fire Department
Traffic Island at Callahan School Street	Harrisville Fire Department
Corner of East Ave. & Harris- ville Main Street	Burrillville Lion's Club
Lewis Bleiweis Park	Burrillville Lion's Club
Clock Tower Spot	Natural Resources Services, Inc.
White Mill Park	Pascoag Pack 1, Cub Scouts & Pascoag Troop 1 Boy Scouts



The Adopt-A-Spot program draws on the generosity of others to help beautify our town. Each space is uniquely designed and kept up by the above sponsors. Please take notice of their beautiful work throughout the spring and summer season!

There are locations still available that need the love and care of volunteers. Please consider adopting a spot, contact Cheryl in the Town Manager's Office at 568-4300, ext. 115

**Police Department**  
**Colonel Stephen J. Lynch, Chief**  
1477 Victory Highway, Oakland  
401-568-6255

---

**NEW E-COMMERCE SAFE ZONE:** The Burrillville Police Department announces the addition of an E-COMMERCE SAFE EXCHANGE ZONE located at the Wallace F. Lees Public Safety Complex, 1477 Victory Highway, Oakland. With the ever-increasing number of people buying, selling, and exchanging goods through popular sites such as eBay, Craigslist, and Facebook, the Burrillville Police Department provides a safe place for citizens to facilitate their transactions and exchanges of merchandise. There are two locations at Police Headquarters for these safe exchanges, both of which are marked with signage designating them as such, and which are monitored by cameras:

- South front parking lot, adjacent to the impound fence.
- Inside the front lobby of the police station.

Please note that no appointments are necessary and you do NOT need to check in with the department when making an exchange. Also note that the Burrillville Police Department will not engage or assist in these transactions, nor will they authenticate payments or exchanges of merchandise. If you have any questions regarding this new E-COMMERCE SAFE EXCHANGE ZONE, feel free to contact Burrillville Police Department at 568-6255.

**NEED HELP SHOVELING SNOW?**

If you are a senior citizen, have a disability, or are dealing with an injury preventing you from shoveling, we have the help you may need. The Burrillville Police Department and students of Burrillville High School have teamed up to help you shovel during the winter. There is no fee for this service as all students are working for community service hours. All interested Burrillville residents who meet the requirements may complete the required registration, available at the police station, or our website at: <http://www.burrillville.org/police-department/news/need-help-shoveling-snow>

Questions can be directed to Officer Veader at 401-568-6255.



**WEBSITE & FACEBOOK:** If you are on Facebook, please take a mo-



ment to look us up and “like” our page. We are striving to keep this page updated with submissions of weekly police logs and photos, as well as immediate announce-

ments such as weather conditions, road closures, missing persons, etc. This page also gives you another avenue to contact this department with posts or private messages. Our website: [www.burrillville.org/police](http://www.burrillville.org/police) is the place to go for general information about programs and happenings as well as access to many downloadable forms. The website is also updated regularly, so take a moment to look us up and add our website to your favorites list.

**WINTER PARKING BAN:** A reminder that Burrillville Town Ordinance 6-1.3 states, “no motor vehicles are permitted to park on any street within the Town of Burrillville between the hours of 1:00 am and 6:00 am from November 1 through March 31 inclusive.” The fine for parking on the streets during these hours is \$15 for each offense. Fines not paid within 7 days will double. Appearance at the Burrillville Municipal Court will be required for those not paying fines, or those wishing to contest a ticket. Any court appearance which does not end in a dismissal will have court costs of \$50 assessed.

**CITIZENS POLICE ACADEMY:** The next Burrillville Citizens Police Academy is scheduled to begin in March of 2016. Applications for this fun, educational, interactive program for adults (and young adults with parental permission) are being accepted now. Seats fill fast and are given on a first-come, first-served basis. Pick up your application at the police station or go to our website [www.burrillville.org/police](http://www.burrillville.org/police) under “downloadable forms.” More information is also available on the website under “community policing programs.”

**NOTARY SERVICE:** You may not be aware of the fact that many members of the Burrillville Police Department are Notary Publics, and there is normally a notary available every shift, 7 days a week. If you are in need of a notary, feel free to stop by the police department any time. This service is provided at no charge. Feel free to call 568-6255 before you come to the station to be sure there is a notary on duty and available.

**CODE RED SYSTEM:** The Burrillville Police Department occasionally sends out notifications to town businesses and residents through a telephone calling system known as CODE RED. Code Red messages can be sent out for various non-emergency situations such as to notify you of a sex offender residing in your area or to inform you of programs or initiatives run by this department. Information on emergency situations such as an Amber Alert for a missing child can also be disseminated through a Code Red announcement. What we have used it the most for, however, is notifying and updating the people of Burrillville regarding threatening weather conditions such as hurricanes and blizzards. It is very important that we keep the Code Red list up to date. You can help by accessing the Code Red database yourself to be sure the information on your family or your business is accurate. You can also add cell phones to receive either voice messages or texts, and add email addresses to receive messages. To access the database, simply go to the Burrillville website at [www.burrillville.org](http://www.burrillville.org) and you will find the Code Red link under the "Residents" tab on the top of the page. The instructions are easy to follow. There is also a link to Code Red under the "Sign Up" tab on our Facebook Page.

We appreciate your cooperation in helping us make the most of the Code Red program.



**MUNICIPAL COURT:** The Burrillville Municipal Court convenes the first and third Tuesdays of each month at the courtroom located within the administration building of the police department. The phone number is 401-568-9494, Ext. 1. Fines may be paid in person at that same location, Monday through Friday from 8 am to 4 pm. The mailing address for the Burrillville Municipal Court is P.O. Box 419, Harrisville, RI 02830. A flyer with more information can be viewed on the police department website at [www.burrillville.org/police](http://www.burrillville.org/police) under the Municipal Court heading. We also have a secure deposit box for Municipal Court payments in the dispatch area of the police station so payments may be dropped off any time of the day or night.

**B-SAFE PROGRAM:** We would also like to remind you once again of a program we run called B-SAFE, which stands for BURRILLVILLE SECURITY & AWARENESS FOR THE ELDERLY. The objective of this program is to make the police department aware of elderly, handicapped, or medically fragile individuals who live in town and may need some extra assistance. It works like this: you fill out a one-page BSAFE form with pertinent information on the subject you'd like to enter into the program. This form can be picked up at Burrillville Police headquarters any time, 24 hours a day, or printed from the "downloadable forms" section of our website: [www.burrillville.org/police](http://www.burrillville.org/police). Once the form is received back at the station, you will receive a call from Lisa Rabideau, program coordinator, to go over the specifics. All data from this form will be entered into our computerized dispatch system, so that whenever a call for emergency services is placed from that residence, dispatchers and officers are immediately aware of any special needs of the person or persons living there. In addition, registrants may choose to receive regular phone calls where we check in and be sure everything okay. If anything is amiss, an officer can be dispatched to the residence and a family member can be contacted. If you would like more information or need a BSAFE form mailed to you, please contact Lisa Rabideau at 401-568-9494, ext. 1.

**VIN CHECKS:** If you have purchased a used vehicle that is a 2001 model year or newer and has an out-of-state title, or you are transferring a vehicle registration from another state, a VIN check verification is required before that vehicle can be registered in Rhode Island. For your convenience, the Burrillville Police Department does VIN checks twice a day, 7 days a week – from 10 – 10:30am and 1 – 1:30pm. You must bring the vehicle with you to the police station during these times, and also must have the **original** out-of-state title and \$10 check or money order made out to the Town of Burrillville. Cash is also accepted for VIN checks but you must have the exact amount.



**RECORD CHECKS & FINGERPRINTS:** Many prospective employers now require state record checks (BCI check) for employees and those positions working with children often require fingerprints and a *national* record check as well. Some volunteer positions may also require these checks. Laws have changed regarding where such checks can be done. Although there are a few exceptions, as a general rule, if a state BCI check only needs to be done, you should get it done through the RI Attorney General's Office. For more information on their walk-in hours, as well as directions on how to obtain a record check by mail, go to their website at [www.riag.ri.gov](http://www.riag.ri.gov) and click on the "criminal records" section. If you need a national record check with fingerprints, call this department at 568-6255 for more information and to make an appointment with a detective. Note that fingerprints being done for school department employees (including sub-contractors of the school department such as bus drivers/monitors and cafeteria workers) cost \$30. Also, please note that NO record checks of any kind are done for juveniles.

**ALARM ORDINANCE:** In 2012, the Town of Burrillville passed an alarm ordinance. Under this law, every building in town (whether business or residence) which has a burglar alarm **must register** with the police department. The ordinance can be viewed on the town website. You can also download an alarm registration form from the website or pick one up at the police station any time. If you need more information, contact the police department at 401-568-6255. Don't wait to get your alarm registered!

**IT IS ALMOST YARD SALE SEASON!** Did you know that posting signs on utility poles, trees, and town property is **prohibited** in Burrillville? Burrillville Town Ordinance Sections 16-74, 16-75, and 16-76 relate to the restrictions and penalties of signage posted on utility poles, shade trees, and town property. What most people don't realize is that, in addition to being unsightly, these postings can create a very real danger to linemen and linewomen working on poles, and can create a distraction to motorists. For the safety of the telephone and electric company workers, our citizens, and others travelling our roads, Burrillville Police officers will be monitoring and enforcing these ordinances. The full ordinances are available for viewing on the Town's website: [www.burrillville.org](http://www.burrillville.org).



## **The Burrillville Lions Club**

P.O. Box 414  
Harrisville, RI 02830  
401-568-4300 Ext.115



The Burrillville Lions Club is a volunteer non-profit organization serving the residents of Burrillville and North Smithfield. The Club was chartered by Lions Clubs International in Burrillville in 1947 and has, on average, 35 to 40 members on the roster. The Club meets the first and third Wednesday of each month, except July and August, at Uncle Ronnie's Red Tavern in Nasonville. Fund raisers are conducted to raise funds for activities such as: conducting the swim program at the Town Beach; providing scholarships for Burrillville high school seniors; supporting the Town's Food Banks; providing dictionaries to all third graders; hosting camps for handicapped children at the Town Beach; Supporting the RI Sight Foundation; supporting the RI Children with Cancer Fund; and adopting families for Christmas support.

Services provided include: conducting eye screening for elementary school children; providing food and support for the Backpack Program; conducting Earth Day Cleanups; assisting residents with eye examinations and glasses; and providing emergency assistance for residents in need.

The Burrillville Lions Club is a part of the Lions Clubs International, the largest service organization in the world, currently with about 1.4 million members. The Club is part of District 42 (all of Rhode Island), has its own Constitution and By-Laws, and elects its officers and board of directors each year to serve annually from July 1 to June 30. There are no paid positions, except at the International level, and all proceeds raised from the public must be returned to the public. Membership is by invitation and must be sponsored by a member of the Club.

Volunteers are always needed and welcomed. If interested, please contact any officer or member, or write to us at The Burrillville Lions Club, P.O. Box 414, Harrisville, RI 02830.

For more information on The Lions Club, visit: [lionsclubs.org](http://lionsclubs.org) or <http://www.burrillville.org/home/news/burrillville-lions-club>

**Burrillville Emergency Management Agency (EMA)**  
**Glen Biddiscombe, Director**  
**(401)- 641-0898**  
[gbiddiscombe@burrillville.org](mailto:gbiddiscombe@burrillville.org)

---

**Hurricane Season**



Please be aware that the hurricane season begins on June 1st. The season ends on November 30<sup>th</sup>. As we have seen in the past with events such as Tropical Storm Irene, unexpected severe weather can strike very quickly. Burrillville EMA asks you to please take the time to prepare or check over your home emergency kit, which needs to have adequate supplies for you and your family to be self-sufficient for 72 hours. Additionally, we remind you to please prepare a family plan. Visit <http://www.ready.gov> for a list of home emergency kit supplies and blank family plan forms.

If you have a medical condition that requires electricity, be sure to have a plan in place should you lose power. Again we ask that you be prepared to be self-sufficient for 72 hours. Burrillville EMA (BEMA) is available 24/7/365 to provide any assistance that may be needed at (401)-641-0898.

**Social Media**

Residents are encouraged to follow us on twitter (@EMABurrillville) and also to check our recently updated Facebook page where notifications and important information will be posted when situations require.



**Code Red Telephone Notification System**

To ensure that your phone number is included on the call down list, or if you would like to add a cell phone number, please visit [www.burrillville.org](http://www.burrillville.org) for further information. This system provides an excellent opportunity for residents to receive important information.

**Rhode Island Special Needs Emergency Registry**

I would like to take the opportunity to invite anyone within the Burrillville community with special needs to register on the RI Special Needs Registry at [www.health.ri.gov/emregistry](http://www.health.ri.gov/emregistry). This secure system allows us to keep track of those who require specialized attention during an emergency. Please sign up today or help out a family member, neighbor or friend.

Any individual, regardless of age, who has a chronic condition, disability, special healthcare need, or may require additional assistance during a time of emergency. Some examples include people who:

- Use life support systems such as oxygen, respirator, ventilator, dialysis, pacemaker, or are insulin dependent;
- Have mobility disabilities and use a wheelchair, scooter, walker, cane, or other mobility device;
- Are visually impaired, blind, hard of hearing, or deaf;
- Have speech, cognitive, developmental or mental health disabilities;
- Use assistive animals or a prosthesis.

#### **EMA office & Emergency Operations Center**

The Burrillville Emergency Management office is located within the Burrillville Police headquarters Complex. When extended emergency conditions exist, the municipal court/community room is transformed to an Emergency Operation Center (EOC) where all management duties including communications, logistics, and documentation are performed. The EOC is also utilized for pre-incident planning involving representatives of all town departments. The center was activated during the month of February during the State of Emergency declared as a result of Blizzard Juno. EMA personnel staffed the center for 41 consecutive hours working with other town agencies providing assistance as needed to ensure the safety of all citizens.



**THANK YOU!**

#### **Interested in learning more about Emergency Management?**

Burrillville has an experienced staff of volunteers who respond regularly when called upon to assist during emergency situations. If interested in becoming part of our team please contact me at any time at 401-641-0898. Please check the

EMA page on the town web site for future messages regarding training opportunities. These trainings are for veteran members of our staff along with those new to the agency.

I thank all our volunteers, veterans and rookies alike for your tireless efforts during emergency situations and during Emergency Management activities for the Town of Burrillville, and remind everyone, "Preparedness begins at home." Visit our page on the Town of Burrillville web site!!

[http://www.burrillville.org/Public\\_Documents/BurrillvilleRI\\_Emergency](http://www.burrillville.org/Public_Documents/BurrillvilleRI_Emergency)



## **Animal Control Shelter**

**Ronald J. Woods, Officer**

131 Clear River Drive, Harrisville, RI 02830

401-568-9480

Mail to: 105 Harrisville Main St., Harrisville, RI 02830

[aco@burrillville.org](mailto:aco@burrillville.org)

---

Welcome Spring! With comfortable weather coming, we are looking forward to allowing our dogs more time outdoors. The spring weather will bring lots of activity at Animal Control.







**Vaccine Information:** We would like to remind everyone to check their pets' vaccinations. Rabies vaccines are required for all dogs, cats, and ferrets. Although Rabies is the only legally required vaccine, other vaccines are important too. There continues to be an increase in canine parvo and influenza activity in Rhode Island. This is a highly contagious virus which is easily transmitted. It is prevented by vaccinating, but is extremely costly to treat and can be fatal to your dog. Lyme and other tick related diseases are also serious health concerns. Protect yourself and your pets from ticks, and check yourself and your dogs after coming in from outdoors.

**Rabies Clinic:** The Annual Town Rabies clinic is being held on Sunday, April 24th, from 10 a.m. – 12 noon at the Highway Garage on Union Avenue. The cost is \$11 per vaccination (cash only). Dogs must be leashed, and muzzled if necessary. Cats and ferrets must be in carriers.

**Spay/ Neuter Clinics:** Kitten season is on the way. Last year, 170 cats and kittens came through the shelter. Please ensure that your cat is not contributing to the overpopulation of unwanted pets. RI law requires that all cats over the age of six months be spayed/neutered. Burrillville Animal Control continues to host low cost spay/neuter clinics for cats on a monthly basis. Services are provided by Dr. Ryan Loiselle of Salmon River Veterinary in their mobile surgery unit, and clinics are held on the Shelter premises. These clinics are for cats only, and the cost is \$75 which includes the spay/neuter surgery as well as Rabies and FVRCP vaccines. Registration is made by contacting Salmon River Vet at 401-793-0092, or you may visit their website at [www.rimobilevet.com](http://www.rimobilevet.com). Low cost spay/neuter services are also available through Ocean State Animal Coalition's RI Community Spay/Neuter clinic. This clinic provides discounted spay/neuter services for dogs and cats, with extra discounts for feral cats and pit bulls. For more information, you can reach them at 401-369-7297, or visit their website at [www.oceanstateanimalcoalition.org](http://www.oceanstateanimalcoalition.org).



### ***Reminders:***

-  There is a leash law in effect for dogs. All dogs must be leashed when off the property of the owner.
-  The dog waste ordinance requires that owners clean up after their dogs when off of the owners' property.
-  2016 licenses are now available and can be obtained at Town Hall with a valid Rabies certificate. All dogs must be licensed by April 30, 2016.
-  In absence of a kennel license, a three dog limit is in effect for single family residences. Duplex and multi-family structures are allowed two dogs per unit.
-  RI Animal Cruelty laws prohibit extended tethering or kenneling of dogs. Tethering is allowed for 10 hours per 24 hour period, and kenneling is allowed for 14 hours per 24 hour period. Only veterinarians and Animal Control officials may authorize a waiver of these limitations.
-  Dogs are pack animals and it is important for their emotional health that they be a part of the family. Please be sure that your pet is not tied or kenneled excessively. Also required is an area free of debris and accumulated feces, potable water at all times, and access to appropriate shelter.

Find us at Facebook at [www.facebook.com/BurrillvilleAnimalControl](http://www.facebook.com/BurrillvilleAnimalControl)



Like our page to keep updated on the goings on at the shelter. We post adoptable pets, lost & found, educational info, fundraising activities, and stories of shelter pets in need. Every like and share helps get our pets seen by more people.

Animal Control now offers a PayPal option for donations! Links can be found on our page on the Town of Burrillville website as well as on our Petfinder.com page and Facebook.



*See the next page for more information about donating.*

**Feral Cats:** We continue to have a large feral cat population within the town. Please do not feed stray and/or feral cats. You may feel that you are helping, but feeding these cats without taking responsibility for them only contributes to the problem of overpopulation. It is also illegal. RI law designates the feeder of cats the legal owner, and therefore that person is responsible for Rabies vaccination and spay/neuter of those cats. If you are feeding a feral cat or colony, please contact us so that we can discuss performing trap/neuter/release services (TNR). TNR controls the reproduction of the colony while naturally reducing the population through attrition. You also have the option of trap/neuter/release on your own using the low cost services mentioned above.

**Important safety tips as we all spend more time outdoors**

- ◆ Do not approach stray animals. Please love your own, leave others alone.
- ◆ Avoid all contact with wildlife. Rabies continues to be a serious issue in the local wildlife population. Report any sick wildlife to DEM or Animal Control. All human and domestic animal contacts with wildlife should be reported.
- ◆ Do not feed pets outside, and please do not feed wildlife. Secure your trash as well.
- ◆ Place identification tags on your pets' collars so they can be returned to you if lost.
- ◆ Make sure that your pets are properly secured and have plenty of fresh water available at all times.
- ◆ Be aware of spills of auto antifreeze/coolant. It is deadly to pets.
- ◆ Please take down bird feeders by April 1st. There is no need to feed birds during the spring/summer/fall. Bird feeders attract rodents, which attract larger wildlife, including black bears. Although the birds may be beautiful to look at while using feeders, feeding birds in the spring and summer months can teach the fledgling population to find food at feeders, leaving them uneducated and unskilled at foraging, and putting their lives in danger during winter months when bird feeders are less accessible.
- ◆ Black bears are also here and will be active in the spring/summer/fall months. Bird feeders make for an easy meal. Again, we ask that you take feeders down, and secure your trash. Clean your outdoor grill regularly also as the high fat drippings can attract a bear.
- ◆ ***Contact our office at 568-9480 with questions, concerns, and animal-related complaints.***

**Important Information Before Adopting a Pet:** Large numbers of private rescue groups have begun operations in the northeast, many of them transporting dogs and cats in from southern and Midwestern states. We urge you to please do your research when considering adopting from these organizations. Along with the increased importation of animals, RI has seen a significant increase in contagious canine diseases. To ensure that you are adopting from a legitimate group that is following RI State regulations regarding importing and animal health, we recommend that you contact the RI DEM Division of Agriculture – Animal Health Division at 222-2781 to confirm that the organization you are working with is licensed with the State. These laws regarding importation and licensing of adoption groups are in effect to protect adopters, incoming animals, and animals already living here. Sadly, when organizations fail to follow proper protocols, it all too often results in an adopter ending up with a new pet with serious illness and/or illness transmitted to another pet already in the household. Working with licensed groups will decrease the risk of unnecessary heartache and expense over a newly adopted pet.



Animal Control continues to receive a significant number of abandoned animals, some in horrific condition, and they need our help. We are proud to work in a community of such generous and caring supporters, and thank you all for your contributions. Working at Animal Control can be hard on the heart at times, but our reward is seeing debilitated animals recover, and placing as many pets as possible in happy and loving homes. We see a lot of sadness and irresponsibility, and along the way we meet wonderful people who want to help and adopt. It is these people who restore our faith and keep us working hard for the animals. Product donations are gladly accepted. Please call to see what items we need most. The Shelter will continue to be in need of ongoing cash donations to cover veterinary expenses. These donations are used solely for veterinary expenses so that we may ensure the best outcome for animals in our care, and healthy pets to those who adopt. Anyone wishing to donate can do so in person at the Shelter, by PayPal on our website, and by mail to: Burrillville Animal Control, 105 Harrisville Main Street, Harrisville, RI 02830. Remember, we are not only an enforcement division, we are also here to help. ***Together we can make a difference!***

## **Spring Lake Beach**

**Judy Lopez, Manager**

50 Old Hillside Drive, Glendale, RI 02826

Telephone 568-9474

E-mail: [jlopez@burrillville.org](mailto:jlopez@burrillville.org)



***Spring Lake Beach will open for the season  
on Saturday, May 28 at 10:00 a.m.***

Admission for opening day is free and resident family passes will be available for purchase with proof of Burrillville residency. Season passes are available for Burrillville residents only: \$30.00 per family pass or \$20.00 for an individual pass. Included in the pass is a parking permit for the resident lot.

General admission for Burrillville residents is \$2.50 per person. Non-resident \$5.00 per person. Groups of 15 or more scheduled in advance are \$1.50 for residents and \$3.00 for non-residents. ***Free admission for up to 3 children per family ages 5 & under when accompanied by an adult. This is not applicable to groups.***

### **Hours of Operations (Weather Permitting)**

#### **Open Weekends Only:**

Saturday, May 28<sup>th</sup> thru Monday, May 30<sup>th</sup> 10:00 a.m. – 6:00 p.m.

#### **Open Daily:**

Saturday, June 4<sup>th</sup> thru Sunday, August 28<sup>th</sup> 10:00 a.m. to 7:00 p.m.

#### **Open Daily:**

Monday, August 29<sup>th</sup> thru Monday, September 5<sup>th</sup> 10:00 a.m. to **6:00** p.m.

The facility offers an arcade, food concessions, restrooms with outdoor showers, new recreation activities, beach shop, picnic tables on a first come first serve basis. Rental equipment including kid kayaks, adult kayaks, kid turbo paddle boats, and paddle boards are available.

During hours of operation the facility has full time lifeguard staff.

**\*Please Note\***

**\*No grills or alcohol allowed on the beach.**

**\*No pets allowed on Spring Lake Beach property.**

\*The Champlin Recreation Hall located at the facility is available for rent during the season rain or shine. Patrons renting the hall are allowed to bring their own grill. No alcohol is allowed. The hall is available to rent from 11:00 a.m.-4:00p.m. More information available on the town web site [www.burrillville.org](http://www.burrillville.org)

Hall bookings are now available by contacting 568-9474 or via e-mail at [Jlopez@burrillville.org](mailto:Jlopez@burrillville.org).



**Walker Safety**

As the warmer weather approaches, more Burrillville residents will be walking in town. Walking is good for your health, and it's good for the environment too. But before heading out on foot for a stroll, power walk, or errand, there are important safety tips to keep in mind:

- \* Increase your visibility at night by carrying a flashlight and wearing light-colored or retro-reflective clothing.
- \* Wear bright colors when walking in daytime.
- \* It's safest to walk on a sidewalk, but if one is not available, walk on the shoulder and face traffic.
- \* Whenever possible, cross the street at a designated crosswalk or intersection.
- \* Don't assume vehicles will stop. Make eye contact with drivers; don't just look at the vehicle.

**Parks & Recreation**  
**Jeffrey McCormick, Director, CPRP**  
**Andrea Hall, Program & Special Project Assistant**  
92 North Main Street, Pascoag  
Telephone 568-9470  
E-mail: [parksandrec@burrillville.org](mailto:parksandrec@burrillville.org)

---

### **ANNUAL EVENTS**

#### **Burrillville Earth Day**

The Parks and Recreation Department along with the Public Works Department and the Burrillville Lions Club are planning their annual Earth Day Cleanup on Saturday, April 23<sup>rd</sup> from 9:00am-1:00pm. Coffee, donuts, T-Shirts, trash bags and gloves will be provided to all participants. Kick-off at 8:30 am at the Burrillville Town Garage (DPW). This is a great event for anyone needing community service hours, and certificates will be printed on site. Can't make the event but still want to cleanup your neighborhood or favorite park? No problem, we will work with you to arrange pickup of supplies for your cleanup. Contact Andrea Hall at 568-9470 or [ahall@burrillville.org](mailto:ahall@burrillville.org) for more information or to sign up. Join us to help Keep Burrillville Beautiful!



#### **Burrillville / Glocester Relay for Life:**

Department will host the annual Relay for Life of Burrillville/Glocester at Branch River Park in Glendale, adjacent to the Middle School. The event will kick off at 4:00pm on Friday, June 24<sup>th</sup> and continue around the clock to Saturday, June 25<sup>th</sup> at 10am. All proceeds benefit the American Cancer Society, which helps save lives and help people stay well, get well, find cures, and fight back. Relay for Life is a family-oriented event, where participants can walk or run on a track, relay style, for 18 hours. Participant's camp around the track, and when they are not taking their turn walking, they take part in other fun activities. Former and current cancer patients, their families, and the public are invited to take part in this exciting team relay event. The team consists of individuals representing corporations, clubs, organizations, families, friends, caregivers and survivors. If you would like more information about Relay for Life, or to donate or sign up a team, please feel free to email Lauren Stone at [Lauren.Stone@cancer.org](mailto:Lauren.Stone@cancer.org) or visit our website at [www.relayforlife.org/bgri](http://www.relayforlife.org/bgri).

## **FAMILY FAIR**

This year's "Old Time Family Fun Fair" is scheduled for June 18<sup>th</sup> with a rain date of June 25<sup>th</sup>. The fair will once again be held at the Stillwater Mill Center and will be a collaboration between the Parks and Recreation Department, the Farmer's Market, and the Jesse Smith Memorial Library. The Fair will feature refreshments, games & activities, demonstrations, face painting, old time photo booth, pie eating contest and informational booths. This year's fair will feature the Roger Williams Park Zoo Zoomobile from 11am-1pm. Check out the Biofact table with animal skulls and bones and visit with zoo educators and their small animal friends. There will be food trucks and Anabel's Ice Cream and plenty of fun for the whole family! There will be several raffles all to benefit the Burrillville Weekend Snack Pack Program.

We are looking for **dedicated volunteers** to assist with the event – community service certificates will be provided. Please contact the Parks and Recreation Department for more information:

[parksandrec@burrillville.org](mailto:parksandrec@burrillville.org) or 568-9470 or Facebook.



## **THE BECKWITH/BRUCKSHAW LODGE** **(COMMUNITY RECREATION CENTER)**

### **Rent the Lodge**

Need a place to hold a fundraiser, birthday party, etc.? The Community Recreation Center is available for rent on weekends. For more information contact the Parks & Recreation Department at 568-9470 or [parksandrec@burrillville.org](mailto:parksandrec@burrillville.org) or Facebook.

### **Program Expansion at the Lodge**

The Department continues to expand programming at the Lodge. We now offer activities during school vacation weeks and the throughout the summer. If you are an instructor interested in teaching at the Lodge or if you'd like more information about the summer programs contact the Parks & Recreation Department at 568-9470 or [parksandrec@burrillville.org](mailto:parksandrec@burrillville.org) or Facebook.

## ONGOING PROGRAMS

(information and location subject to change)

Program	Location
After School Multi-Sport	Levy, Callahan, and Steere Farm
Art Classes	Levy, Callahan, Steere Farm & The Lodge
Children's Dance classes – jazz/hiphop, acro/gymnastics	The Lodge
Archery	The Lodge
Tai Chi & Qigong	The Lodge
Healthier Fit Lifestyle	Jesse Smith Library
Fencing	Levy
Forever Fit	The Lodge
Yoga	The Lodge
Safe-sitter program	Burrillville Middle School
Craft Workshops	The Lodge
Zumba	The Lodge
Home Alone Safety Classes	Jesse Smith Memorial Library
Sunshine Club	Parks & Rec Office
Hula Hoop Classes	The Lodge
Adult/Teen Art Workshops	The Lodge

### **Hula Hoop Classes**

Classes are held each Wednesday from 5 pm to 6 pm. The cost is \$9 per class drop-in or a monthly fee equal to \$7 per class. Classes are held at the Burrillville Community Recreation Center (Beckwith-Bruckshaw Lodge). Think outside the hoop!! Hoop classes teach waist hooping as well as on-body and off-body tricks and routines. It's fun exercise meets hoop dance. Contact Instructor Marcia Colledge (Gypsy Blue) at 309-5297 or e-mail at [in.the.hoop.hula.hoops@gmail.com](mailto:in.the.hoop.hula.hoops@gmail.com) for information.

 **Picnic in the Park** Pack a picnic lunch and come check out our three new parks! The Parks and Recreation Department and the Jesse Smith Library have teamed up this summer to offer a fun way to meet new friends and enjoy our new playgrounds. On your mark, get set, READ! Join us for Story Time at 10:30 followed by some fun playground games and activities. All ages welcome. June 29<sup>th</sup> (Stillwater Playground), July 27<sup>th</sup> (White Mill Park) and August 24<sup>th</sup> (Hero Park). If it rains, Story Time will take place at the Jesse Smith Library. For more information contact Andrea Hall at Parks and Recreation [ahall@burrillville.org](mailto:ahall@burrillville.org) or 568-9470 or Lisa Stratton at the Jesse Smith Library [lstratton@burrillville.org](mailto:lstratton@burrillville.org) or 710-7800.



### **Healthier Fit Lifestyle**

Lose weight to keep it off, get fit and have fun! Learn good nutrition, weekly weigh-in, group discussion and support, exercises requiring no equipment (outdoors if weather permitting!), and enjoy tasty food samples and Recipes. All sessions open to men, women and teens. Registration is required. Sessions are 6 weeks long and meet on Wednesdays, from 6:00-7:30pm at the Jesse Smith Library. Fee of \$65 per participant. For questions contact Lorraine Fisher at 401-568-7508 or [raindrop6lf@yahoo.com](mailto:raindrop6lf@yahoo.com).

*The Department offers a wide variety of programs and activities throughout the year. Newsletters and calendars are available at the Town Hall, the Parks & Recreation Office, the Community Recreation Center (Beckwith-Bruckshaw Lodge), or by visiting the Town's website at [www.burrillville.org](http://www.burrillville.org) or Facebook.*

To register, or for information regarding any of the Parks & Recreation programs, contact 568-9470 or via e-mail at:

[ParksandRec@Burrillville.org](mailto:ParksandRec@Burrillville.org) or Facebook.

### **April Vacation Fun!**

#### **April Vacation Multi-Sport Mini Camp at the Callahan Gym**

April 19<sup>th</sup>, 20<sup>th</sup>, and 21<sup>st</sup> from 9am -12pm. The children will have an opportunity to experience new sports while having fun and making new friends. Skilled and experienced instructors (Coach Gino will be back!) will conduct the program focusing on Kickball, Whiffle Ball, Basketball, Soccer, Capture the Flag and More! Children will learn new skills and how to be part of a team. Sneakers required. Fee: \$55 (\$40 for siblings) Ages: 6 through 12. To register contact Frank Luca at 639-0814 or e-mail at [frank@1on1basketball.com](mailto:frank@1on1basketball.com).



#### **Burrillville Weekend Snack Pack Program Packing Sessions**

Join the volunteers of the BWSP to help us pack bags for the remainder of the school year. Families are welcome to attend packing sessions held at the Beckwith Bruckshaw Lodge during April Vacation on Monday, April 18<sup>th</sup>, and during Summer Vacation on Wednesday, August 10<sup>th</sup>. Volunteers will meet at 10:30 am. Contact Parks and Recreation with questions at 568-9470 or e-mail at [parksandrec@burrillville.org](mailto:parksandrec@burrillville.org) to register.

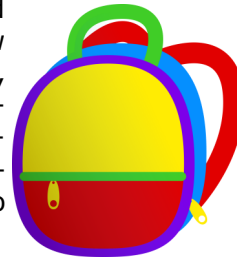

### **Safe Sitter Class**

Thursday, April 21st from 8:00am -2:30pm at Burrillville Middle School Media Center for students ages 11-14. Learn safe childcare practices, good babysitting skills, and how to be a responsible adolescent. Instructors are enthusiastic and committed to teens. Most are registered nurses and all are certified to teach the safe sitter class. Instruction for this 1-day program includes: Babysitting as a Business, Preventing Injuries, Success on the Job, Injury Management, Child Care Essentials, Safety for the Sitter, Preventing Problem Behavior, Behavior Management, Care of a Choking Infant/Child, and Rescue Breathing. Cost: \$45, includes all materials. Advance registration is first come, first serve. For more information or to register for the class, please call (401) 431-5410 and ask the operator for Robin Zaman.

### **Sunshine Club**

The Sunshine Club meets once per month at the Parks and Recreation Department to make homemade floral arrangements, crafts and cards to share at the local nursing homes to celebrate any patient's upcoming birthdays. There is no cost to participate. If you are interested in being part of spreading some sunshine to our Burrillville community members, please contact the Parks & Recreation Department at 568-9470 or e-mail us at [parksandrec@burrillville.org](mailto:parksandrec@burrillville.org) or Facebook.



### **Burrillville Weekend Snack Pack Program**

BWSP is a not for profit joint effort between Burrillville Parks and Recreation, the Burrillville Lions Club, the Jesse M. Smith Memorial Library, and the Berean Baptist Church to provide weekend food for needy Burrillville youth. Currently there are 35 children who receive the weekly backpacks and 5 who receive weekly snacks for school. The average monthly cost for the food is \$900. Food or monetary donations can be dropped off to the Burrillville Parks and Recreation Department or the Jesse M. Smith Memorial Library. Please make checks payable to the Burrillville Weekend Snack Pack Program. Non-perishable kid friendly food (macaroni and cheese, granola bars, juice boxes etc.) is accepted. For more information on volunteering, or for a complete list of suggested donation items please contact the Parks and Recreation Department at 568-9470 or [parksandrec@burrillville.org](mailto:parksandrec@burrillville.org) or Facebook.

## **Summer Programs**

### **One on One Basketball Camp**

Will be offered for ages 6 to 9 (8:30 am to 11:30 am) and ages 10 to 16 (8:30 am to 2:00 pm) July 18<sup>th</sup>, 19<sup>th</sup>, 20<sup>th</sup>, and 21<sup>st</sup> at the Burrillville Middle School. The fee is \$75 per participant for the morning session, \$95 per participant for the full day. Participants will work on Individual Skills Competition, Skills Stations, Shooting & Offensive Skills. Experienced Coaches, Free T-shirts, and Written Evaluations. To register, please contact Frank Luca, Regional Director, at (401) 639-0814, or email [Frank@1on1basketball.com](mailto:Frank@1on1basketball.com).

### **Summer Multi-Sport at the Callahan Gym**

Two weeks of multi-sport fun will be offered in June and August at the Callahan Gym. June 20<sup>th</sup>, 21<sup>st</sup>, 22<sup>nd</sup>, and 23<sup>rd</sup>, and August 15<sup>th</sup>, 16<sup>th</sup>, 17<sup>th</sup> and 18<sup>th</sup> from 9am-2pm with an 8:30am early drop off option. The children will have an opportunity to experience new sports while having fun and making new friends. Skilled and experienced instructors will conduct the program focusing on playground and sports games, learning new skills and how to be part of a team. Parents/Guardians are required to pack a cold bag lunch & drink per child. Sneakers required. Fee: \$80 each for the full week (\$65 for siblings) or \$25 per day. Ages: 6 through 12. To register, please contact Frank Luca, Regional Director, at (401) 639-0814, or email [Frank@1on1basketball.com](mailto:Frank@1on1basketball.com).

**More summer programs to be announced!** Watch for the Parks and Recreation Summer Program Flyer in May for more information on Karate, Art, Hula Hoop and Archery Camps! Information and flyers will also be available at the Family Fair.

**Are you looking for an opportunity to volunteer for your community?** Volunteers are always needed to assist with our special events. Please contact us at 568-9470 or [parksandrec@burrillville.org](mailto:parksandrec@burrillville.org) or Facebook.



### **SIGN UP FOR RECREATION NEWS**

Subscribe to receive Recreation Department News by visiting [www.burrillville.org](http://www.burrillville.org) and clicking on 'E-Subscribe' tab on the left hand side of the page. Click on 'Parks and Recreation' under News and Announcements to sign up for email notifications regarding programs and events sponsored by the Parks and Recreation Department.

## **PARK NEWS**

### **Bike Path**

Run, walk, bike, or rollerblade on the bike path! Our bike path is a 1.2 mile off-road bike path that runs along the former New York, New Haven and Hartford Railway and connects the villages of Harrisville and Pascoag. The paved path has entrances along Mowry Street and Eastern Avenue. At about the halfway point of the bike path there is a paved path with benches and picnic tables that leads towards Duck Pond. The paved path ends at a small cul-de-sac, and a dirt path continues up over a small hill toward the pond. There are benches along the bike path to rest and both picnic tables and benches near the pond.

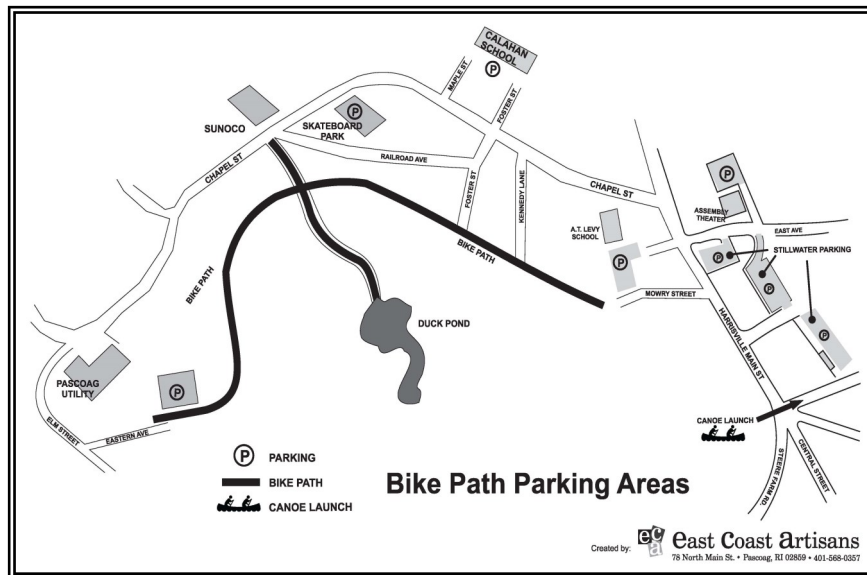

### **Skateboard Park**

The skateboard park located on Chapel Street is open daily from 9am until dusk. Helmet, knee pads and elbow pads required! Please adhere to all Rules & Regulations posted at the park.





**THIS IS AN UNSUPERVISED PARK. THE TOWN OF BURRILLVILLE  
WILL NOT ASSUME RESPONSIBILITY FOR INJURIES.**

**USE OF THIS PARK IS AT YOUR OWN RISK.**

Skateboarding, rollerblading, scooter riding and BMX bicycle riding can be a HAZARDOUS ACTIVITY that may result in SERIOUS INJURY. The use of personal safety gear and equipment (helmets, elbow pads, kneepads and protective clothing) is strongly recommended.

The use of a protective helmet is mandatory for anyone  
15 years of age or younger.

No use allowed when equipment is wet or icy.  
No use allowed during lightning storms.

Please be respectful and courteous of other users and neighbors.

Abusive, threatening or obscene language is prohibited.

Alcohol, Tobacco and Drugs are prohibited.

If you see someone acting inappropriately,  
be a mentor and a leader and share tips on skate park etiquette.

No competitive or demonstration events are allowed without prior approval  
of Parks and Recreation Department.

Keep the park clean – No glass containers inside the fenced area. Please  
use the town recycling and rubbish containers. No littering allowed!

**In case of emergency - Police/Fire/Medical: Dial 9-1-1**  
**Report vandalism, suspicious or criminal activity to:**  
**Police Department 568-6255 or Parks & Recreation Department 568-9470**

## **Department of Public Works**

Jeffrey M. McCormick, P.E., Director

65 Union Avenue, Harrisville

Telephone: (401) 568-4440 Fax: (401) 568-9469

Hours: 6:30 a.m. to 3:00 p.m. Monday through Friday

---

### **Town Senior Minibus**

The Town of Burrillville Department of Public Works offers a minibus transportation service for eligible residents of Burrillville. To be eligible for this service, Burrillville residents must be 62 years old or older or totally disabled. The minibus operates on a regular schedule and will pick up any eligible Burrillville resident upon request. The schedule is as follows:

- Mondays, Tuesdays and Thursdays – bus available for doctors' appointments between 9 a.m. and 2 p.m.

- Wednesdays – bus available for grocery shopping trips to the Village IGA Marketplace in Pascoag

Fridays – bus is available for scheduled trips for up to 12 people for excursions or shopping trips around the state

This bus service is available on a first come, first served basis, and is free of charge to Burrillville residents.

***Please call Allison at 568-4440 ext.10 with any questions or to schedule the minibus.***



***Alternately; all residents can call RIPTA flex Service for trips within designated areas in town or No. Smithfield. Call 1-877-906-3539 (fares apply)***

### **Maintenance Projects**

The Town of Burrillville Department of Public Works continues to work on regular maintenance projects of street sweeping, road side brush cutting, tree trimming, catch basin cleaning, roadway repairs and drainage improvements.

**DPW small projects** –Pavement repairs on sections Joslin and Summer St. and various drainage improvements throughout town - Roosevelt Ave, Fredrick St, Gig Rd, Rock Ave, N. Shore.

**DPW Summer Crew** – The summer crews will be maintaining all of the Town Parks and Recreational facilities.

## **Construction Projects**

Construction projects also to be undertaken this construction season include:

- **North Road Bridge** - Reconstruction
- **Bridgeway paving and sidewalk improvement** - To match state project.
- **Municipal Court Overflow Parking Lot** – To be located east side of police station.
- **Spring Lake Beach** – Brown House completion, beach sand, additional kiddie Slide.
- **Wilson Reservoir Spillway** – Demo & reconstruction Fall 16/ Winter 17
- **Lake Shore Drive, Beach, Highland, Shady, Maple Terrace, Lake View.** Drainage installations and prep for next season's reclamation and repaving.
- **Crack Sealing** – Various roads
- **Neighborhood Projects** – Small drainage improvement projects throughout town.

## **State Projects**

The DPW is coordinating with the RIDOT regarding the schedules, design and construction of state projects within the town of Burrillville. These projects include:

- RIDOT, Pascoag Rt. 107 1R overlay project (Union Ave to Rt. 100). Preliminary utility work done, Construction starts this spring. Lynch Construction has contract.
- RIDOT, Improvements to Old Route 102 -Victory Highway – Route 7 to ½ mile west and from East Avenue to Mapleville Main Street.
- RIDOT, Shippee Bridge, Repair and replacement. Construction starts in March.

*More current projects on the following page.....*



## **Engineering Projects**

**DPW Engineering Projects** – The Director of Public Works has been working with consultants on numerous future construction projects to prepare feasibility studies, construction plans, technical specifications, permits and various annual reports.

- Sayles Ave – Design of roadway widening and sidewalk reconstruction
- Bridge/Culvert railing replacement program
- 2017 road construction design/const. package
- Pavement Management Program – ongoing road rating system
- RIPDES annual storm water reporting
- Landfill groundwater and gas monitoring
- DPW facility design, Clear River Drive.
- Recreation Center Beckwith Lodge expansion feasibility study

---

**Department of Public Works**  
**Refuse & Recycling**  
**Andrea Hall, Recycling Coordinator**  
401-568-4440 ext. 12  
[ahall@burrillville.org](mailto:ahall@burrillville.org)

---

**Changes to Recycling of E-Waste-** In July 2014, the state collection program for electronic waste (E-waste) was cut down to only five locations. Burrillville was not selected to be one of the five. At that time we were able to find a company to handle the recycling of our E-waste in the same manner as the state program, accepting all of the same items at no cost to the Town. Rhode Island falls under a manufacturer take back program which is overseen by the State, and restrictions made it no longer feasible for them to collect here or in other Rhode Island cities and towns.

Effective immediately residents are instructed to take their **hazardous E-waste (computers, laptops, monitors, tablets, and TV's)** to one of the five state collection program locations (Johnston/RIRRC, Little Compton, Barrington, Coventry, and Narragansett). These locations will only accept hazardous E-waste. **Hazardous E-waste is banned from the landfill and will result in a fine if found in the trash.**



**Please be sure to dispose of your Hazardous E-waste properly—by bringing to one of the five state collection program locations.** For more information visit: [www.rirc.org/ecodepot](http://www.rirc.org/ecodepot). Non-hazardous plastic E-waste (keyboards, mice etc.) go in a bag in trash cart. Non-hazardous metal E-waste (VCR/CD/DVD players with metal cases) can go in the Metal dumpster at the Whipple Ave. Recycling & Compost Facility.

Currently residents also have a **local option** for E-waste disposal. Residents can contact Northeast Computer Recycling (NECR) in Town at 401-678-6057 or [necrecycling@gmail.com](mailto:necrecycling@gmail.com). *NECR does not accept CRT TVs, and there is a \$10 fee for disposal of CRT monitors.* There is no fee to schedule a pickup/drop off for other types of E-waste. Please visit their website for a list of acceptable E-waste items: [www.northeastcomputerrecycling.com](http://www.northeastcomputerrecycling.com).

The Town will also be holding a hazardous E-Waste Collection in Burrillville during our Eco-Depot and Shred Event on July 16<sup>th</sup>. Residents can bring hazardous E-Waste listed above from 8am -1pm. No appointment necessary.

Thank you for your patience as we adjust to the new way of handling E-waste. If you have any questions please contact [ahall@burrillville.org](mailto:ahall@burrillville.org) or 568-4440x12.

### **Recycle Rate Update**

Burrillville's current recycle rate is 31.4%. Residents continue to do a great job, however there are many items still ending up in recycling carts that are not recyclable. Recycling loads that are contaminated or contain prohibited items may be rejected at the MRF. A rejected load costs the Town \$250, and all the contents of that load must be landfilled at \$32/ton. No one wants this to happen! While nobody's perfect and mistakes happen, please do your part to keep the following items (all seen recently in the recycling) OUT of your recycling bin:

**Food, leaf and yard debris, construction and demolition debris, clothing, textiles, and tarps, plastic bags, recyclables IN plastic bags, diapers, tires, chains, cables, wires, ropes, hoses, household hazardous waste, propane tanks, scrap metal and paint.**

**Please take the time to review the list of accepted items. For any questions on the Do's and Don'ts of recycling in RI, please visit [www.RecycleTogetherRI.org](http://www.RecycleTogetherRI.org), or contact the Town's Recycling Coordinator.**

Burrillville has made great strides in recycling, and we continue to research ways to increase our recycling rate. Currently we are focusing our efforts on increasing recycling in our schools, parks and fields, and raising awareness of roadside litter. Thank you for helping to Keep Burrillville Beautiful! Thank you for recycling!

**Field Trips:** It's not too late to book a field trip to the landfill to see how the single stream sorting process separates our Town's recyclables. Field trips are free! If you would like to book a field trip for your school or group please contact Andrea Hall at 568-4440 x12 or [ahall@burrillville.org](mailto:ahall@burrillville.org).

### Upcoming Recycling Events

#### April 23<sup>rd</sup>, Annual Earth Day Cleanup:



Kicks off at the Town Garage (DPW) at 8:30am. Cleanup runs from 9am to 1pm. Coffee, donuts, T-Shirts, trash bags and gloves will be provided to all participants. Community Service Certificates will be printed on site. Giveaways & Raffles! Can't make the event but still want to cleanup your neighborhood or favorite park? Contact Andrea Hall at 568-9460

or [ahall@burrillville.org](mailto:ahall@burrillville.org) for more information or to sign up.

**Month of April, Earth Day Poster Contest:** The Burrillville Parks and Recreation Department, Jesse M. Smith Memorial Library & The Pascoag Utility District are teaming up to hold a poster contest in honor of Earth Day. Students that are residents of Burrillville are encouraged to create a POSTER that demonstrates how you can help or protect the environment by recycling or saving energy. Twelve posters will be chosen to create The 2016 Environmental Education Calendar which will contain energy conservation and recycling information. A calendar will be given to the 12 students whose artwork is featured in the calendar and 6 Cash Prizes will be awarded in 2 Categories: Best Recycling & Best Energy Conservation Posters: 1<sup>st</sup> Prize: \$50.00, 2<sup>nd</sup> Prize: \$30.00, 3<sup>rd</sup> Prize: \$20.00. Contact Lisa Stratton at the Jesse Smith Library: 710-7800 or Andrea Hall at Parks and Recreation: [ahall@burrillville.org](mailto:ahall@burrillville.org) or 568-9470 for more information.

**April 21st, Earth Day Poster Workshop, Craft & Storytime:**

Thinking about entering a poster in our Earth Day Poster Contest? Stop by the Jesse Smith Library to make a poster, hear an Earth Day Story and make an Earth Day Craft. Participate in one, or all three activities. Town Recycling Coordinator and Pascoag Utility District Staff will be on hand to answer Recycling & Energy Conservation questions. Contact Lisa Stratton at the Jesse Smith Library: 710-7800 or Andrea Hall at Parks and Recreation: [ahall@burrillville.org](mailto:ahall@burrillville.org) or 568-9470 for more Information.

**May 17th—Earth Day Poster Contest Awards Ceremony:** An award ceremony will be held on May 17<sup>th</sup>, 2016 at the Jesse M. Smith Memorial Library at 6pm to honor the winners of the Earth Day Poster Contest. Light refreshments will be served. Contact Lisa at the Jesse Smith Library: 710-7800 or Andrea at Parks and Recreation, [ahall@burrillville.org](mailto:ahall@burrillville.org) or 568-9470 for more information.



**July 16th, Eco-Depot & Shred Event:** at the Whipple Ave Recycling & Compost Facility, Eco-Depot Hazardous Waste Collection, from 8:00am to 1:00pm. Residents should call RIRRC at 942-1430 x 241 to make an appointment. Hazardous Waste Collection will also include **Hazardous E-Waste** (computers, monitors, laptops, and TVs.) **Shred**

**Event** runs from 9:00am-1:00pm. Residents are limited to one box of documents per person to minimize wait time. Whipple Ave will be open for regular service during the Eco-Depot & Shred Event. Contact Andrea Hall at 568-4440 x12 or [ahall@burrillville.org](mailto:ahall@burrillville.org) for info on what items are accepted at Whipple Ave Recycling & Compost Facility.

**September 10th, Green Festival:** Event runs from 10:00am to 2:00pm at the Stillwater Mill Complex. A rain date is scheduled for September 24<sup>th</sup>. Visit with Green Vendors, learn about energy conservation and recycling at this community event offered by the Pascoag Utility District and Department of Parks and Recreation. Recycle your CFL light bulbs, make a recycled craft and enjoy food and beverages prepared by a local food truck. For more information contact Desarae Dolan at the Pascoag Utility District: 401-568-6222 x223 or [ddolan@pud-ri.org](mailto:ddolan@pud-ri.org) or Andrea Hall at Parks and Recreation: [ahall@burrillville.org](mailto:ahall@burrillville.org) or 568-9470 for more information.

## Weekly Setout Reminders

- ⇒ Trash and recycling carts are the property of the Town.
- ⇒ No markings are permitted on the cart other than in the white address label on the top of the lid.
- ⇒ Place one cart on each side of the driveway **or** place carts 3ft apart from one another and from other obstacles.
- ⇒ Place carts no more than 3ft away from the curb or road edge.
- ⇒ Arrows on the cart lid must face the street
- ⇒ **Cart lids must be fully closed with no material sticking out**
- ⇒ No material may be placed on top of the cart lid.

### Why is it important to recycle as much as we can?

Recycling saves the Town money! The more we recycle, the less trash we generate, and the less trash we have to tip at the landfill at a rate of \$32/ton. In addition the more we recycle, the larger the profit share we will receive from RIRRC.

The Central Landfill is running out of room. If we don't start taking more recyclables out of the waste stream it is estimated we will only have enough space in the landfill for another 22 years. When the landfill is full, Rhode Island municipalities will have to bring our Solid Waste elsewhere at a rate of approximately \$96 per ton.

## Refuse & Recycling Information

**Residents can obtain information about delays due to weather events or holidays in one of three ways:**

1. Visit the Refuse & Recycling webpage [www.burrillville.org/refuse](http://www.burrillville.org/refuse)
2. Check the Refuse and Recycling Voicemail Message (568-4440 x12)
3. Sign up to receive Public Notice Emails on the main page of the Town website [www.burrillville.org/subscriber](http://www.burrillville.org/subscriber).

As soon as Waste Management notifies the Town of any issues causing a delay or cancellation, that information is made available to residents. Information is updated immediately even when a decision is made after normal working hours, including over the weekend.



**LOVE YOUR TOWN**  
*Keep BURRILLVILLE Beautiful*  
**DON'T LITTER**

**Weekly Curbside Pickup:** Residents are allowed one BLACK lid Town owned cart for trash, and one YELLOW lid Town owned cart for recycling. Place trash and recyclables curbside no more than 24 hours before and no later than 7:00 AM on your scheduled collection day. Excess trash can be placed next to the cart in a Town approved Overflow Bag. Excess recycling can be brought to the Whipple Ave Facility and placed in the Mixed Recycling dumpster.

**Bulky Items:** Bulky items are collected twice per month for a fee of \$16 per item. A bulky item is an item of solid waste that is not recyclable and is too large to fit inside a bag placed inside the Town provided cart. Examples include couch, chair, desk, rugs, carpets, etc. Call Waste Management to schedule a pickup at 1-800-972-4545. Residents with a large amount of bulky items can utilize the Bagster Program. Contact the Town's Recycling Coordinator for information on Bagster bags, 568-4440 x12 or [ahall@burrillville.org](mailto:ahall@burrillville.org). Bulky items left curbside for a period of more than one day are in violation of Section 22-43 of the Solid Waste Ordinance and may be subject to fines and penalties.

**Appliances/White Goods:** Appliances are collected twice per month for a fee of \$19 per item. Appliances include washers, dryers, stoves, refrigerators, air conditioners etc. Call Waste Management to schedule a pickup at 1-800-972-4545. Non-Freon appliances can be brought to Whipple Ave for no fee. Local metal recyclers advertising in the Bargain Buyer will often pickup Freon appliances at no charge.

**Cart Maintenance:** Residents are responsible for periodic cleaning/disinfecting carts, properly storing carts when not in use, and cart replacement due to normal wear and tear. Contact the Recycling Coordinator for repairs to cart wheels, axles, lids and hinge pins.

**Exchanging Carts:** Residents can exchange their 65-gallon Town owned trash cart for a larger 95-gallon cart for a onetime charge of \$50. 65-gallon recycling carts can be exchanged for a larger 95-gallon recycling cart for no fee. Carts to be exchanged must be clean and in good condition. A \$15 administrative charge will be assessed if the Town delivers and exchanges the carts. Residents may exchange their 65-gallon carts for smaller 35-gallon carts for no fee. A \$15 administrative charge will be assessed if the Town delivers and exchanges the carts. No administrative charge will be assessed if the resident exchanges

the carts at the Department of Public Works. Exchanged carts are subject to availability.

**Overflow:** Residents with excess trash can purchase Town Overflow Bags at DPW and IGA. Bags are \$3 each and are sold in sleeves of 5 of IGA. Residents can purchase single bags at DPW.

### **Recyclable Items Accepted in the YELLOW lid Recycling Cart**

#### **Recyclable Items Accepted in the YELLOW lid Recycling Cart**

- \* Milk & juice cartons
- \* Juice boxes (remove straws)
- \* Glass containers
- \* Plastic containers (up to 5 gallons. Disregard the numbers and triangle)
- \* Metal and aluminum cans, metal lids, foil & pie plates
- \* Mixed paper, newspapers and inserts
- \* Thin cardboard –cereal/pasta boxes, tissue boxes etc. (No refrigerated containers: beer, soda or frozen food boxes)
- \* Shredded paper (double bag in clear or white plastic bag)
- \* Corrugated cardboard (must be flat, cut into pieces that fit loosely in cart)
- \* Pizza boxes that are not greasy

Empty & rinse all recyclables. Replace plastic caps and trigger sprays. Place recyclables loose in the cart. No plastic bags in your recycle cart unless they contain shredded paper.

For an extensive list of recyclable items visit: [www.burrillville.org/refuse](http://www.burrillville.org/refuse) or call 401-568-4440 x12 with questions.

### **Recycling Reminders**

- \* Greasy pizza boxes, paper packaging from frozen/refrigerated foods, beer/soda packaging are NOT recyclable
- \* Juice pouches (Capri sun etc.) and straws are NOT recyclable
- \* Styrofoam is NOT accepted in your recycle cart
- \* Plastic bags are NOT accepted in your recycle cart unless it is a clear or white plastic bag containing shredded paper
- \* Any plastic container 5 gallons or less IS now recyclable in your yellow lid cart
- \* Plastic caps and covers can now stay on your plastic containers
- \* Scrap metal and wire hangers are NOT accepted in your recycle cart. Please bring to the Whipple Ave Recycling and Compost Facility



## **How Do I Dispose of...?**

**Books**: Books that are in good condition can be placed in the Kiduca-tion bin at DPW.

**Compact Florescent Light Bulbs (CFLs)**: Bring to Pascoag Utility Dis-trict, an Eco-Depot, or check your local hardware store.

**Computer Ink Cartridges** -Bring to DPW to be donated to the Burrill-ville Lions.

**Construction/Demolition Debris**: Anything that was or could be at-tached to your home is considered construction debris. Examples in-clude windows, shower doors, wood, bathtubs, toilets, sheet rock etc. Bring to RIRRC, hire a private hauler, or use the Bagster program.

**Electronics (E-waste)**: TV's, computers, monitors and laptops— bring to one of five state collections including RIRRC. Call 942-1430 for more information and hours. Some items are accepted by local E-waste recy-cler Northeast Computer Recycling (NECR) Call 401-678-6057 or email at nerecycling@gmail.com for more information.

**Excess Waste due to a Large Cleanout or Renovation**: Hire a private hauler or use the Bagster Program. Contact the Town's Recycling Co-ordinator for information on Bagster bags.

**Hazardous Household Waste**: Chemicals, fertilizers, propane tanks, oil based paint, pool chemicals, gasoline, transmission fluid, etc. - Bring to Eco-Depot. Call Rhode Island Resource Recovery @ 942-1430 ext. 241.

**Medical Syringes**: Place in hard plastic container (laundry detergent bottle, bleach bottle etc.) seal cap tightly with duct tape and place con-tainer in the *trash*.

**Plastic Bags**: Tie in a knot and drop off at any ReStore bin, including Brigido's IGA.

**Pellet Bags** : Drop off at any ReStore bin, including Brigido's IGA.

**Prescription Drugs**: Bring to Burrillville Police Department. Do not flush down the toilet.

**Styrofoam**: Bring to RIRRC. Foam must be clean, dry and bagged in clear or translucent bags. Food service foam (like coffee cups and food trays) must be bagged separately from all other foam. No spongy foam (#1 Fan fingers etc.) and no packing peanuts. Call Rhode Island Re-source Recovery @ 942-1430 for more information.

**Used Cooking Oil**: Bring to RIRRC.

**Used Motor Oil, Oil Filters, Car Batteries**: Dispose of at DPW during normal business hours. 5 gallon limit for motor oil.

## **Whipple Ave. Recycling & Compost Facility Information**

Open every Wednesday & Saturday

from 9:00 AM TO 1:00 PM, weather permitting.

Proof of Residency is required to use the Whipple Ave Facility.

### **Items ACCEPTED at the Whipple Ave. Recycling & Compost Facility**

**Christmas Trees** – First two Wednesdays and Saturdays in January from 9:00 AM to 1:00 PM. Trees must be cleaned of all ornaments and tinsel. No plastic bags permitted.

**Clothing & Textiles** — Includes items suitable for reuse and items to be processed as rags. Place in Clothing & Textile Bin at The Whipple Ave Recycling & Compost Facility.

**Excess Recyclables/Single Stream Recyclables** – Large cardboard and excess recyclables that would normally go in your yellow topped cart.

**Mattresses/Box-Springs**—No futon mattresses, mattress pads, or toppers. No severely damaged, wet, twisted, frozen or soiled mattresses.

**Metal (scrap)** – bicycles, rims, lawnmowers (drain oil/gas), grills (cleaned), exercise equipment, pipes, metal cabinets, and other miscellaneous scrap metals.

**Non-Freon Appliances** – stoves, washers, dryers, dishwashers

**Plastic (Rigid)** - Children's toys, vacuums, hose reels, lawn furniture, etc.

**Tires** – must be off the rim. Limit of 4. No oversized tires.

**Yard Waste** – brush must be 4" diameter or less & cut in 5' lengths or less. Place leaves in paper bags only.

***If your trash or recycling was not picked up please call Waste Management at 1-800-972-4545.***

If you have **questions** about how to recycle certain items, or **concerns** about your trash or recycling pickup please contact the Recycling Coordinator – Andrea Hall at 568-4440 x 12 or [ahall@burrillville.org](mailto:ahall@burrillville.org). Visit our website for detailed information [www.burrillville.org/refuse](http://www.burrillville.org/refuse).

### **Overflow**

Residents with excess trash can purchase Town Overflow Bags at DPW and IGA. Bags are \$3 each and are sold in sleeves of 5 of IGA. Residents can purchase single bags at DPW.





## BOY SCOUTS OF AMERICA

### "Be Prepared"

---

**Cub Scouts** is a program for first-graders through fifth graders that teaches while having fun, focusing on character development, teaching practical skills and enhancing their community spirit. Cub Scouts are made up of Den's (groups of boys) for each grade. They meet once a week during the school year and then get together for a Pack meeting once a month to show what they've learned and receive their awards. There are two Cub Scout packs in town.

Cub Scouts are run by trained volunteers and is a wholesome, worthwhile program for any male youth. For more information about Pack 1 Pascoag, please contact Florence Stevens at 401-568-0395, or by email at [newtfla@cox.net](mailto:newtfla@cox.net) For more information about Pack 102 Mapleville, please contact Chris Samek at 401-568-2220 or by email at [cfsamek@cox.net](mailto:cfsamek@cox.net)

**Boy Scouts** begin in fifth grade and can stay in until they're 18 years old. Every day they are encouraged to live by the 13 points of the Scout Law. A Scout is trustworthy, loyal, helpful, friendly, courteous, kind, obedient, cheerful, thrifty, brave, clean, and reverent. They are taught skills of the world around them by earning merit badges.

Boy Scouts are grouped by rank, not by grade. All boys start off as a Scout, then advance to Tenderfoot, Second Class, First Class, Star, Life and Eagle Scout. The Troops are separated into groups of similar ranks and skills, called Patrols. All the boys meet once a week and have a "Court of Honor" 3 times a year where they are recognized and are presented their awards.

There are three Troops in town. For more information about Troop 1 Pascoag, please call Newton Stevens at 401-568-0395 or his email at [newtfla@cox.net](mailto:newtfla@cox.net). For more information about Troop 100 Pascoag, please contact Rick Lacouture at his email [kimrick97@verizon.net](mailto:kimrick97@verizon.net). For more information about Pack 102 Mapleville, please contact Tom Sylvester at his email [catdonto@cox.net](mailto:catdonto@cox.net).



## **JESSE M. SMITH MEMORIAL LIBRARY**

**Beth Ullucci, Director**

100 Tinkham Lane, Harrisville, RI 02830

(401) 710-7800 Fax: (401) 710-7772

[www.jmslibrary.org](http://www.jmslibrary.org) or visit us on Facebook



As winter nears its end, don't forget the Friends of the Jesse Smith Library's 2016 Friday Night CoffeeHouse series. This free program features original music performed by area musicians. Attendees for the first 3 shows enjoyed the music. We hope you join us for the final three shows on Friday, April 8; Friday, May 20 and Friday, June 17 from 7 to 9 pm; doors open at 6. Coffee and donuts are provided by our local Dunkin' Donuts. All are welcome to attend. Funding is provided by our very active Friends of the Library group.

By the way, anyone can join the Friends of the Library and help with activities like the CoffeeHouse, the Riverwalk Times, the twice yearly Silent Auctions or the used book sales, just to name a few of their activities. They meet on the 1<sup>st</sup> Wednesday of each month at 6:30 pm and they welcome new members.

Even during the colder months the library remains busy. In a typical week we welcome adults looking for pleasure reading or movies to watch; high school kids studying for mid-terms or kids coming in for storytimes, science club or to build with LEGOs. Despite predictions that reading is on the decline, you wouldn't know it from the people who come through the doors. We have old and young patrons who love books! In addition to physical books, regular or large print, our readers get their library books in a few different ways. Some may read on their e-readers such as a Kindle or an iPad while others are listening to their books on CDs as they drive or knit. By the way, if you need a book suggestion, please ask: We love to talk about books!

Our book discussion group continues meeting monthly here at the library. A different book is chosen with input from the group and the librarian leader. Keep an eye on the library's webpage, newsletter and Facebook page for these updates. There is a library-sponsored bookclub at Stillwater Heights which we help to facilitate. If there are other community groups which need help getting started with a book discussion group, let us know and we'll be glad to help.

Of course the library is a destination for reasons aside from books and movies. There are those who come in to use the Internet. We're always happy to help you print directions, tickets, photos, recipes or resumes. We have a copier which also serves as a scanner. We have flash drives (aka thumb drives) at the reference desk if information needs to be transferred from the scanner to your email. We give help with these tasks daily so don't be afraid to ask!

We continue to offer one-on-one computer help to anyone who asks. If it's a simple question, we can help you right away. If it's more involved, we ask if we can set up a time so we can sit down with you and your laptop for more in-depth assistance. This winter we offered a new class called "iPad Tips & Tricks" which gave iPad owners a chance to learn more about their devices in a small group.

Other programs for adults are the monthly craft programs where we've created with Sculpey clay, designed silk scarves, made sun-catchers for the window, strung beads for bracelets and made tea-light snowman ornaments. We offer the same class twice during the month, one morning and one evening.

Also, for adults who are creative, you can stop in and get a coloring sheet to work on here in the library or to take home. There are many publishers creating books with coloring sheets that have intricate patterns for coloring. It's a fun, relaxing way to spend time.

Our Wednesday afternoon Teen Hangout from 2:30 to 4:30 grows in popularity each week. It is an afterschool destination for food, games and fun. We open the Community Room and have the Wii gaming system on, a simple craft and snacks. Kids in grades 6 and older can come in to hang out with their friends. A library staff member remains in the room at all times, of course.

Adults, teens and kids have been enjoying our monthly contests on the first floor. Utilizing our display case we've offered a chance to win a book bag with new books and a Dunkin Donuts gift card by guessing how many items are in the case. The most popular guessing game was in October when we had 190 people guess how many Beanie Babies were in the display (there were 184.) Library visitors also guessed how many balloons and origami cranes were in there too.



Ongoing library programs for adults are: **Trivial Pursuit** which is held on Saturday mornings from 10 to 12 noon and the 2nd Tuesday of each month at 7 pm in the library conference room. This free program does not require registration. Be sure and call to confirm that the program is being held.

**The Adult Writing Group** is held the 1<sup>st</sup> and 3<sup>rd</sup> Wednesday of each month from 6:30-7:45 pm. This group provides a supportive atmosphere where writers can share ideas and experience with other writers.

**The Thursday Knitting Group** is open to knitters ages 10 to 100! Held each Thursday from 6 to 7:45 pm in the Children's Program Room, the knitters have extra yarn and needles ready for newcomers. Bring your projects to knit, chat and meet new friends.

**Rhode Island Library Day is April 16** and the library plans to celebrate with a unique, staff-created indoor mini-golf course for patrons to play along with some raffles and giveaways.

#### **News from the Children's Room**



If you hear chirping in the library this spring, don't worry, it's the chicks! We look forward to the return visit from Casey Farm in Saunderstown. Just like last year when they brought us an incubator and eggs so we could hatch some Rhode Island Red chicks right here in the library, we'll do it again this year. Everyone is welcome to visit the Children's Room to see the chicks and hear how noisy they can be!

The Children's Room presented a very well-attended Finding Nemo event in February. Library staff members and volunteers created an undersea world which delighted everyone who came through the doors. We had 140 visitors on that cold day who warmed up in the with this family activity.

Our ongoing programs in the children's room include the Wednesday afternoon Science Club, the twice weekly LEGO building times on Tuesday and Saturday afternoons, the monthly elementary book discussion & writing group and of course our story programs for our youngest patrons and their grown-ups. We have Mother Goose time which offers rhymes, songs and movement for ages 0-2; Toddler Storytimes which offers rhymes, songs, movement, creativity and stories; and preschool Storytime which focuses more on books and a craft but is still lots of fun!

We look forward to the summer when the library hosts a popular community event: the **Riverwalk Times Concert Series**. Last year 2018 people enjoyed music on our Riverwalk at our Saturday night concerts. This year we are featuring 8 concerts on Saturdays at 6 pm.

Bring your family, enjoy the beautiful location and some fantastic music. We have something for everyone. This series is also paid for by the Friends of the Jesse Smith Library along with support from local businesses and organizations. This year's lineup is:

**JULY 9 TOE JAM PUPPET BAND**, *a dynamic and interactive children's musical group with songs, puppets and storytelling. Come ready to laugh and dance.*

**JULY 16 JESSE LIAM BAND**, *always a foot-stomping, hand-clapping thoroughly enjoyable concert. The band plays original music and hits from 50's to today. Be prepared to leave with a smile on your face.*

**JULY 23 BRASS ATTACK**, *Southern New England's finest live dance band. Enjoy a nine-piece band featuring four horns, a rhythm section, and a lead vocalist, performing classic hits from the 30's to today.*

**JULY 30 THE AVIATORS**, *an awesome Burrillville band making its return to the Riverwalk. Playing the hits of the 50s through the present day. Dance the night away!*

**AUGUST 6 THE GREG WARDSON TRIO**, *an amazing trio of exemplary jazz musicians known for cool jazz standards and contemporary classics. You will be singing along and laughing.*

**AUGUST 13 LIVE MUSIC BAND**, *a classic rock & roll band playing music from the 60's, 70's, 80's & 90's*

*High energy performances that keep you dancing all night long.*

**AUGUST 20 SLIPPERY SNEAKERS**, *a high energy Zydeco dance band. Sure to be a rousing good time.*

*Bring your dancing shoes. It is not summer without a visit from this amazing band!*

**AUGUST 27 WHISKEY RHODE**, *a fantastic rock & roll dance band. Playing classic and contemporary, Rock, Rhythm & Blues and even some country. Great way to end our concert series.*



### **Summer Reading Programs at the Jesse M. Smith Library**

This summer we join the other libraries around the state in hosting a summer reading program with a theme of being active. It's **On Your Mark, Get Set, Read** in the Children's room while Teens can "**Get in the Game**" and adults should "**Exercise Your Mind: Read**"! All three programs are set up with rewards for readers.

Once you sign up, check back in with your reading log and earn prizes! We'll host a few special programs including a return visit from the RI Museum of Science and Art offering their DaVinci Catapult workshop for teens and a fun interactive and silly show with artist Eric Fulford for kids. These programs are sponsored by the state library office.

Check back at the library when summer starts to sign up for our summer reading programs. They are always a lot of fun. We thank the Friends of the Library for their financial support for these programs as well.

---

## **Ladies' Pascoag Library Association**

### **d/b/a Pascoag Public Library**

57 Church Street

Pascoag, RI 02859

Tel: 401-568-6226

Fax: 401-567-9372

Web: <http://pascoaglibrary.org>

FOUNDED IN 1871, SERVING THE TOWN FOR 145 YEARS

---

Pascoag Library is open 26 hours per week and is a full service library providing the same services as larger libraries while retaining the small-town ambience. Patrons can borrow materials from all the public libraries in the state through the Ocean State Libraries (OSL) network. It has 16,500 volumes of hardcover fiction, non-fiction, classics, children's books, adult and children's DVD's, and audio books including the latest bestsellers in both fiction and non-fiction.

#### **The library is open as follows**

WINTER hours: Monday, 1 to 8 p.m.; Wednesday & Thursday 10-12 p.m. and 3-6 p.m.; Friday, 1-6 p.m.; and Saturday, 9 a.m. – 1 p.m.; Sunday, Closed.

SUMMER hours: Monday, 1-8 p.m.; Tuesday, 1-5 p.m.; Wednesday & Thursday 10-12 p.m. and 3-6 p.m.; Friday, 1-6 p.m., Saturday & Sunday, closed.

Pascoag Library periodically offers early childhood literacy programs such as “Mother Goose on the Loose,” Sleepy Time Stories, Baby Time Lapsits and Lego Clubs. Pascoag will also be introducing a “Game Time”, an informal playtime program, and young adult book club programs this fall. The Children’s Summer Reading Program is held each year in July and August. A variety of adult and family programs are also held throughout the year.

Pascoag is in the process of updating our website. Keep informed of activities at Pascoag Library or reserve a book from your home computer through the online catalog using your library card. E-books can also be accessed through the online catalog.

Six Dell desktop computers and seven laptop computers are available for public use with color laser printing capability. Black and white printing is 10 cents a copy and color is 25 cents a copy. A wireless printer with scanner, photo printing and color copying capability is available – price for printing photos is 30 cents each.



A fax and copy machine is also available for use by the public. The charge for a fax is \$1.00 for local numbers and \$2.00 for long distance numbers. Copies are 10 cent each for black & white; 25 cents each for color copies.

Pascoag also has wireless  access for those who wish to bring their own laptops.

A Microfilm Reader/Printer is also available for use by patrons. The library has copies of the “Burrillville Gazette” (Feb. 12, 1880 to March 5, 1887). From March 12, 1897 through December 19, 1899 it was called “The Herald and Burrillville News Gazette.” There is also the “Pascoag Herald” from April 1892 through April 12, 1918 and the Woonsocket Call from 1928 to 1948. Pascoag’s collection does not overlap with the new Microfilm printer recently acquired by the Jesse Smith Library.

## PASCOAG LIBRARY



## **HISTORY**

The Pascoag Public Library was the first library in the town of Burrillville. It was founded in 1871 by a group of women who called themselves the Pascoag Union Sewing Society. In 1873 they renamed themselves the Ladies Pascoag Library Association, appointed a librarian, and purchased 163 books which were housed in the librarian's local store. The Library moved four times between 1883 and 1899 when Samuel Mellor offered the use of a room rent free over his mill office on Sayles Avenue where it remained until 1913 when it moved to the Steere Building on Main Street. At this time charges associated with the loan of books were discontinued and the library became known as the Pascoag Free Public Library.

A bequest of \$500 from Miss Rosamond A. Steere stipulated that the money be used for a free public library building within ten years. This started the building fund which grew through numerous fundraisers and donations. The present home of the Pascoag Public Library at 57 Church Street was erected in 1924. The Library is still privately owned by the Ladies Pascoag Library Association and governed by the Board of Trustees which is still composed of all women.

Pascoag Library is only partially subsidized by the town of Burrillville for operating expenses. All improvements to the property and equipment owned by the library have been obtained over the years through various grants received from sources such as the Champlin Foundation and the Levy Foundation.

Construction of a 36x22 ft. addition to the library was completed in June, 2011 which was the 140<sup>th</sup> anniversary of its' founding. In November 2010 Pascoag Library received a \$252,000 grant from the Champlin Foundation and a \$20,000 grant from the Levy Foundation to FULLY FUND this addition. Since Pascoag Library is a privately-owned, tax-exempt entity NO TOWN MONIES WERE INVOLVED; AND THERE IS NO IMPACT ON THE TAXES OF THE RESIDENTS OF BURRILLVILLE.

Pascoag Public Library is an integral part of the history of the town of Burrillville.





## School Committee Contact Information

<b>Mark Brizard</b> Chairperson 571 Victory Highway Mapleville, RI 02839 (401) 567-9275	<b>John M. Karmozyn</b> Vice-Chairperson PO Box 19 Glendale, RI 02826 (401) 568-3745	<b>Silvia St. Pierre</b> Clerk 130 Maple Drive Harrisville, RI 02830 (401) 568-8885
<b>Dorothy Cardon</b> PO Box 638 Glendale, RI 02826 (401) 568-4913	<b>Alexandra LeClair</b> P.O. Box 24 Glendale, RI 02826 401-636-7600	<b>Donison Allen</b> 451 Lapham Farm Rd. Pascoag, RI 02859 401-568-6832
<b>Joshua Tessier</b> 245 Jackson Schoolhouse Road Pascoag, RI 02859 401-371-2888		

## School Department Contact Information

<b>Superintendent of Schools</b> Dr. Frank Pallotta (401) 568-1301 pallotta@bsd-ri.net	<b>Director of Pupil Personnel Services</b> Kimberly Pristawa (401) 568-1301 pristawak@bsd-ri.net	<b>Supervisor of Business Affairs</b> Robin Kimatian (401) 568-1301 kimatianr@bsd-ri.net
<b>Director of Technology</b> Justin Allen (401) 568-1301 allenj@bsd-ri.net	<b>Director of Facilities</b> David Fontes (401) 568-1301 fontesd@bsd-ri.net	<b>Food Services Manager</b> Jen Palmer (401) 568-1360 palmerj@bsd-ri.net
<b>Director of Curriculum Assessment, and Professional Development</b> Lois Short (401) 568-1301 shortl@bsd-ri.net		

For the latest information about our schools, please visit the Burrillville School Department website at **[www.bsd-ri.net](http://www.bsd-ri.net)**. Below are just a few of the items you will find:

- ◇ School Calendars including dates for report cards & progress reports
- ◇ School Closing Information
- ◇ District Curriculum
- ◇ Special Events
- ◇ Lunch Menus
- ◇ School Committee Policy

***From our Home Page you can also connect to individual school websites.***

## Burrillville School Department: A Community Partner

In this current article for the Bugle, the Burrillville School Department would like to highlight a few of the ways that we work as a community partner. In particular we will discuss the following plans.

- ◆ **Maintain safe and secure schools** for students and staff
- ◆ Create a future population of students able to manage the **technological demands** of home, work and community
- ◆ Create **Business Partnerships** that prepare future citizens for a career path that builds upon their strengths and leads to future employment
- ◆ Prepare for potential community **population growth** as it affects schools



### Maintain Safe and Secure Schools

The school department buildings are a capital asset of the community collectively consisting of 541,844 square feet and valued at over \$100,000,000. As every home owner knows, it is hard to reverse the signs of wear if those signs have been neglected for years, especially for structures as large as our schools. Thanks to a town funded 5 year capital improvement project, we are working to ensure that our facilities will be safe and secure for current and future students. In a previous article we highlighted some of the safety enhancements completed. In this article we will concentrate on infrastructure and energy efficiency projects. Many energy initiatives have included incentive rebates from Pascoag Utility and National Grid. Below is a very brief update of some of the projects underway.

Infrastructure Projects	Energy Projects
New dual fuel boiler at the Burrillville Middle School	New stairwell LED fixtures at BHS with occupancy and daylight sensors
Plans and specifications for exterior work at the William L. Callahan School	The installation of 2,070 LED lamps at BMS classrooms
Replacements scheduled for this summer for the BHS Cafeteria roof and the upper roof at BMS	The installation of 129 LED fixtures in the corridors at BMS

## Year 1: 2015-2017 Technology Plan

This year our schools have received **1/3 of the computers needed to allow every student in the district access to a device as a natural tool for learning**. If we were asked to describe what was in our classrooms just a few years ago, we would think desks, pencils, pens, books, paper, etc. Today, all of those items are still available. However, included in the list of supplies, is a Wi-Fi connected device that allows access to information whenever a student needs to know more. As we teach English and science, social studies and art, students can pull up a painting by an artist being discussed or an author that is unfamiliar to the student. A student can create their rough draft of a written response on computer using the tools available to move text and check spelling. In other words, a student can begin to build skills that mirror the type of work he/she will face in a post-secondary setting, workplace or home office.

## Building a School & Community Partnership

There are several factors that have spurred Superintendent Dr. Frank Pallotta to begin to develop a collaborative effort between local businesses and Burrillville High School. One of the resounding facts that emerged from the Substance Abuse Task Force/Burrillville Prevention Action Coalition is that if a student leaves high school without marketable employment skills, that student is much more likely to turn to drugs and alcohol. A second is Commissioner Ken Wagner's focus on career paths for students that are identified early in a student's high school career and supported throughout their high school experience. To address these issues, Dr. Pallotta has created a plan of action that will span several years. Over the next few months, community members will be invited to join a committee charged with making the mission and vision represented below a reality.

**Mission Statement** The mission of the Burrillville School-Business Partnership is to collaboratively build effective pathways for students entering college and careers.



**Vision Statement** The vision of the School - Business Partnership is to enhance the existing academic culture by creating meaningful pre-career and college opportunities for students connected to their areas of interest, expertise, and future employment.

## **Proactively Preparing for Community Population Growth Redistricting**

Because the school district observed a growing disparity in enrollment between William L Callahan and Steere Farm Elementary, the Superintendent formed the Redistricting Committee to analyze the long term shift in population growth. The committee consists of parents, teachers, school committee members, and administrators from each of the five (5) schools in the district. Thanks to projected housing starts data provided by Mr. Tom Kravits, Burrillville Town Planning Director, the committee is currently deciding how best to adjust the boundary lines established for school attendance at either Steere Farm or Callahan and/or the grades housed at each of our buildings. Once a recommendation has been voted upon by the Redistricting Committee and approved by the School Committee, the shift will effect students in the fall of 2017. That will allow ample time for planning and communication with parents.

## **The Burrillville Conservation Commission**

---

The Burrillville Conservation Commission's mission is to protect and preserve the natural tranquility of the local natural reserves, features and attributes that defines the Town of Burrillville's natural characteristics which draws people to this community to enjoy the rural atmosphere, scenic vistas, recreational opportunities and many qualities of life. The Conservation Commission is responsible for the establishment of a seven-member party that serves as an appointed board reporting directly to the town council, planning board, zoning board and the many municipal employees that constitute the town's government.

Some of the wonderful areas the Conservation Commission manages are as follows:

1. Joseph O. Brock Blanchard – Nipmuc Trail, located off of Round Top Road, ¼ mile north of Smith Road. Trail is for public walking, hiking & fishing on 200+ Acres of land along the Nipmuc River.
2. Wallum Lake Canoe Launch, located off South Shore Road on scenic Wallum Lake. Site is strictly for canoeing, kayaking and fishing. Swimming is prohibited.
3. Clear River Canoe Launch, located off Clear River Drive just behind the Burrillville Animal Control Facility. Access allows scenic exploration of the Clear River from the site to points south along Clear River towards Mill Pond in Oakland.

The Conservation Commission also provides natural resources to our residents on Earth Day, at the Annual Family Fair and other Town sponsored programs throughout the year. View the local listings for upcoming events.

**Burrillville Sewer Commission**  
**Burrillville Wastewater Treatment Facility**  
**William Andrews, Chairman**  
141 Clear River Drive, Oakland 02858  
(401) 568-6296

---

The Board of Sewer Commission is comprised of five (5) members. The members are currently William Andrews, Chairman, Richard Nolan, Vice Chairman, Russell Fontaine, Secretary, William Peterson and Raymond Trinque. The Commission holds meetings on the second Tuesday of each month at 9:00 a.m. in the Board Room of the Wastewater Treatment Facility. If you would like an item placed on the agenda, it must be received at this office by the 1<sup>st</sup> Tuesday of the month no later than 4:00 p.m.

**Sewer Use Charges**

The sewer use rate for FY16 is \$444.00 a year for a single family dwelling. At the present time, residential sewer use charges are mailed three (3) times a year in July, November and March in the amount of \$148.00 per unit. Please note that failure to receive a bill does not negate the requirement to pay the bills when they are due.

**Sewer Assessment Charges**

Sewer assessment bills are mailed out once a year in the month of July. Homeowners can choose to pay the sewer assessment in a lump sum or over a 20 year period. If you choose the 20 year payment plan, you can at any time make additional payments to the assessment or pay in full.

**Please note should you sell or transfer your property, the sewer assessment is not transferrable to the new owner.**

**Any assessment balance must be paid in full at time of sale.**

**If you are having financial difficulties please contact this office as soon as possible so that we can set up.**



## **Payment**

Bills can be paid in person at the Wastewater Treatment Facility or by mailing to: P.O. Box 71, Harrisville, RI 02830. Please note that there is a drop box located to the left of the rear entrance to the Town Hall from the parking lot for your convenience during non-working hours. **Please note on the front of the envelope that it is a sewer payment and checks only - No Cash.**

Please note that we now have in service the credit card option to pay your bills. Customers may now view and pay their balances on line or pay at the office using their Master Card or Visa Cards.

**Please check the bottom of your bill for the site and your Pin # to access your account. The credit card company does charge a 3% fee for this service.**

## **Congratulations!!**

The Burrillville Sewer Commission was selected as a 2015



Regional EPA Operation and Maintenance  
Excellence Award Recipient.

The Commission was nominated by the Rhode Island Department of Environmental Management to acknowledge the outstanding work that has performed over the years by John Martin, Superintendent and his staff.

**We are looking for businesses generating jobs.**

***The town has acreage for sale  
(with water and sewer available)  
at Commerce Park.***

*If you or someone you know is looking to locate or expand a business, please contact the Town Manager or Town Planner at 568-4300 ext.115 or 131.*

*Commerce Park is Located off Route 102 between Central Avenue and Lapham Farm Road.*

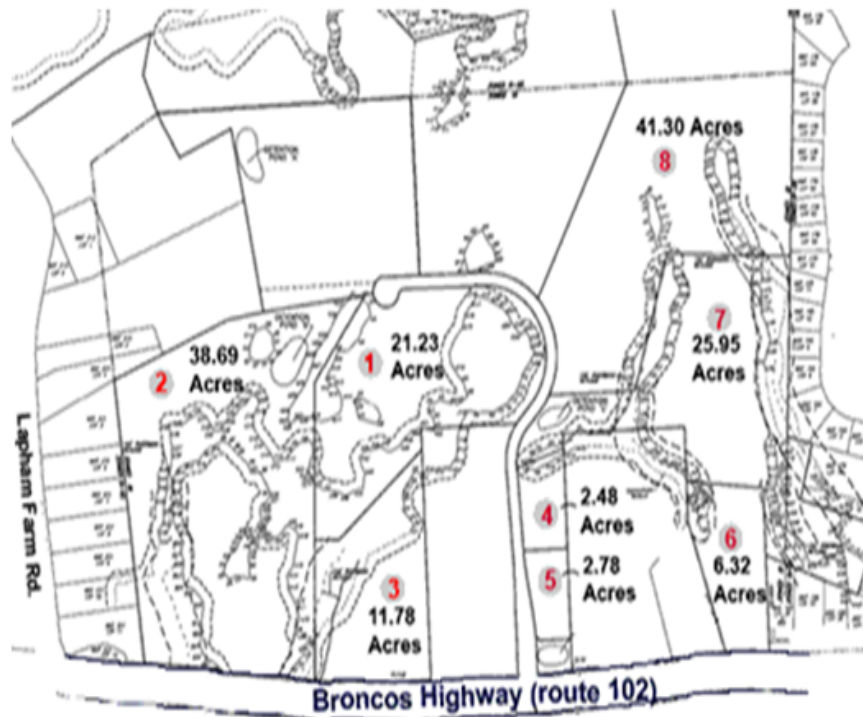

**Commerce Park  
Burrillville, Rhode Island**



## **Your Local Fire Departments**



### **Harrisville Fire Department**

Mark St. Pierre, Chief

201 Callahan School Street, Harrisville, RI 02830

Business Telephone: 568-5110

### **Nasonville Fire Department**

Robert Howe, Chief

2577 Victory Highway, Nasonville, RI 02830

Business Telephone: 568-5020

### **Oakland-Mapleville Fire Department**

Joseph E. Bertholic, Chief

46 Oakland School Street, Oakland, RI 02858

Business Telephone: 568-5720

### **Pascoag Fire Department**

Harold (Butch) Carter, Chief

**Hose #1** 105 Pascoag Main Street, Pascoag, RI 02859

Business Telephone 568-4470

**Hose #2** 141 Howard Avenue, Pascoag, RI 02859

Business Telephone 568-4920

### **Wallum Lake Fire Department**

Robert Bishop, Chief

P.O. Box 354, Pascoag, RI 02859

Business Telephone: 568-9019

Note: Business telephones are not manned at all times. Dispatch at the police department can be used for emergencies 568-6255

***For emergencies dial 911***



***Give Back to Your Community***

***with a sense of pride!***

***Inquire about volunteering!\****



## **Town of Burrillville Post Offices**

---

### **Harrisville Post Office**

131 Harrisville Main Street, Harrisville, RI 02830

Wendy Demarais, Postmaster

Mon. - Fri. Retail Hours: 8:30 a.m.- 1:30 p.m. & 2:30 - 4:45 p.m.

Lobby Open: 7:00 a.m. - 5:30 p.m.

Sat. Retail 9:00a.m. - 12:00 p.m., Lobby Open 7:00 a.m. to 12:00 p.m.

568-9075

### **Glendale Post Office**

1916 Victory Highway, Glendale, RI 02826

Wendy Demarais, Postmaster

Marlene Dupre, Clerk

Mon. - Fri. Retail Hours: 10:00 a.m. - 1:00 p.m. & 2:00 p.m. - 4:45 p.m.

Lobby Open 6:00 a.m. - 6:00 p.m.

Sat. Retail: 8:30 - 11:30 a.m., Lobby Open 6:00 a.m. to 3:00 p.m.

568-8782

### **Pascoag Post Office**

35 Bridgeway, Pascoag, RI 02859

Christopher Jackson, Postmaster

Mon.- Fri. Retail Hours, 8:15 -12:30 p.m. & 1:30 -4:45 p.m.

Lobby Hours: 7:00 a.m. - 5:00 p.m.

Sat. Retail 8:30 a.m. -11:30 a.m., Lobby Open 7:00 a.m. to 12:00 p.m.

568-8790

### **Mapleville Post Office**

963 Victory Highway, Mapleville, RI 02839

Wendy Demarais, Postmaster

Christopher Lafrance, Clerk

Mon.-Fri. Retail Hours: 8:30 - 12:30 p.m.

Lobby Open 7:00 a.m. to 5:00p.m.

Sat. Retail 9:00 to 11:30 a.m., Lobby Open 8:30 a. m. - 12:00 p.m.

568-7312



## **TOWN OF BURRILLVILLE 2016 MUNICIPAL DIRECTORY**

(M-W 8:30-4:30, Th 8:30-7:00, Fri 8:30-12:30)

### **Town Hall**

105 Harrisville Main St., Harrisville  
Main Number: 401-568-4300

[www.burrillville.org](http://www.burrillville.org)  
FAX: 401-568-0490

Town Manager, Michael C. Wood: X115  
Finance Director, John Mainville: X117  
Town Clerk, Louise Phaneuf: X114  
Board of Canvassers: X112  
Tax Assessor, Susan Makar: X126  
Treasurer, Mark Adams: X123

E-mail: [manager@burrillville.org](mailto:manager@burrillville.org)  
E-mail: [finance@burrillville.org](mailto:finance@burrillville.org)  
E-mail: [townclerk@burrillville.org](mailto:townclerk@burrillville.org)  
E-mail: [townclerk@burrillville.org](mailto:townclerk@burrillville.org)  
E-mail: [assessor@burrillville.org](mailto:assessor@burrillville.org)  
E-mail: [finance@burrillville.org](mailto:finance@burrillville.org)

### **Town Hall Annex** (M-W 8:30-4:30, Th 8:30-7:00, Fri 8:30-12:30)

144 Harrisville Main Street, Harrisville  
Main Number: 401-568-4300

FAX: 401-710-9307

Building Official, Joseph Raymond: X128  
Town Planner, Tom Kravitz: X131  
IS Manager, Edward Pienkos: X129

E-mail: [building@burrillville.org](mailto:building@burrillville.org)  
E-mail: [bplanning@burrillville.org](mailto:bplanning@burrillville.org)  
E-mail: [mis@burrillville.org](mailto:mis@burrillville.org)

### **Police Department**

Chief: Colonel Stephen J. Lynch

E-mail: [bpd@burrillville.org](mailto:bpd@burrillville.org)

1477 Victory Highway, (Mailing address, PO Box 231 Harrisville, RI 02830)

Dispatch: 568-6255

FAX: 568-9499 TDD: 568-5006

Detectives: 568-9459

Emergencies: 911

EMA Director: 641-0898

### **Public Works Department** (M-F, 6:30-3:00) E-mail: [dpw@burrillville.org](mailto:dpw@burrillville.org)

Director/Town Engineer, Jeffrey M. McCormick, PE

65 Union Avenue, Harrisville

Office: 568-4440

FAX: 568-9469

### **Parks And Recreation** (M-F, 8:30-4:30)

E-mail: [parksandrec@burrillville.org](mailto:parksandrec@burrillville.org)

Jeffrey M. McCormick, Director—Andrea Hall, Program & Special Project Assistant

92 North Main Street, Pascoag

Office: 568-9470

FAX: 568-9457

Community Recreation Center, 300 Church St., Pascoag

Spring Lake Beach Manager, Judy Lopez (Memorial Day – Labor Day) 568-9474

Extended Day Care Program 915 Steere Farm Rd. Harrisville: 568-1356

### **Waste Water Treatment Facility**

(M-Th, 8:30-4:00, Fri 7:30-3:00)

141 Clear River Drive, Oakland

Superintendent: John Martin

Office: 568-6296 FAX: 568-9464

E-mail: [bwtf@burrillville.org](mailto:bwtf@burrillville.org)

### **Animal Control**

131 Clear River Drive

Animal Control Officer: Ron Woods

Office: 568-9480

FAX: 568-9471

E-mail: [aco@burrillville.org](mailto:aco@burrillville.org)

### **Jesse M. Smith Memorial Library**

100 Tinkham Lane, Harrisville

Library: 710-7800 FAX: 710-7772

E-mail: [jmslibrary@yahoo.com](mailto:jmslibrary@yahoo.com)

### **Pascoag Public Library**

57 Church Street, Pascoag

Library: 568-6226 FAX: 568-9372

E-mail: [pascoaglibrary@gmail.com](mailto:pascoaglibrary@gmail.com)



## State Government Officials

<b><u>Governor</u></b> Gina Raimondo <a href="http://www.governor.ri.gov">www.governor.ri.gov</a>	<b><u>Lieutenant Governor</u></b> Daniel McKee <a href="http://www.ltgov.ri.gov">www.ltgov.ri.gov</a>
<b><u>Secretary of State</u></b> Nellie Gorbea <a href="http://www.sos.ri.gov">www.sos.ri.gov</a>	<b><u>Attorney General</u></b> Peter Kilmartin <a href="http://www.riag.ri.gov">www.riag.ri.gov</a>
<b><u>General Treasurer</u></b> Seth Magaziner <a href="http://www.treasury.ri.gov">www.treasury.ri.gov</a>	



District 23, Paul W. Fogarty, [sen-fogarty@rilin.state.ri.us](mailto:sen-fogarty@rilin.state.ri.us)

District 47, Cale P. Keable, [rep-keable@rilin.state.ri.us](mailto:rep-keable@rilin.state.ri.us)

District 48 Brian C. Newberry, [rep-newberry@rilin.state.ri.us](mailto:rep-newberry@rilin.state.ri.us)

Burrillville Town Hall  
Office of the Town Manager  
105 Harrisville Main Street  
Harrisville, RI 02830